

- Notes:
1. Locks located 9" up from frame bottom of each stile (2 total).
 2. Items L & J located in one hole of tie bar guide (1 total per guide).
 3. Item G located in outside holes of operator base (2 total).
 4. Item K located in one hole of snubber (1 total per snubber).

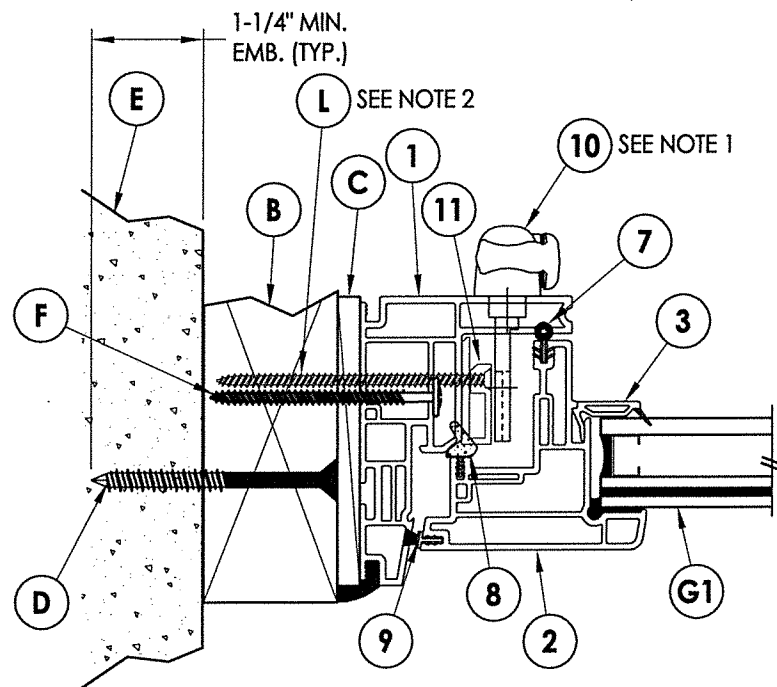

1 HORIZONTAL CROSS SECTION
2 Shown w/ 2X buck

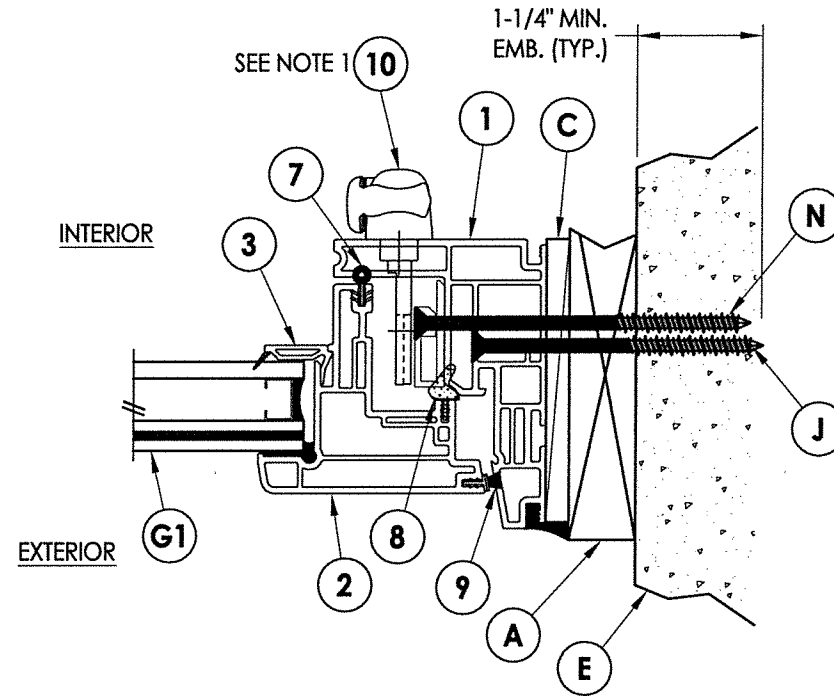

2 HORIZONTAL CROSS SECTION
2 Shown w/ 1X buck

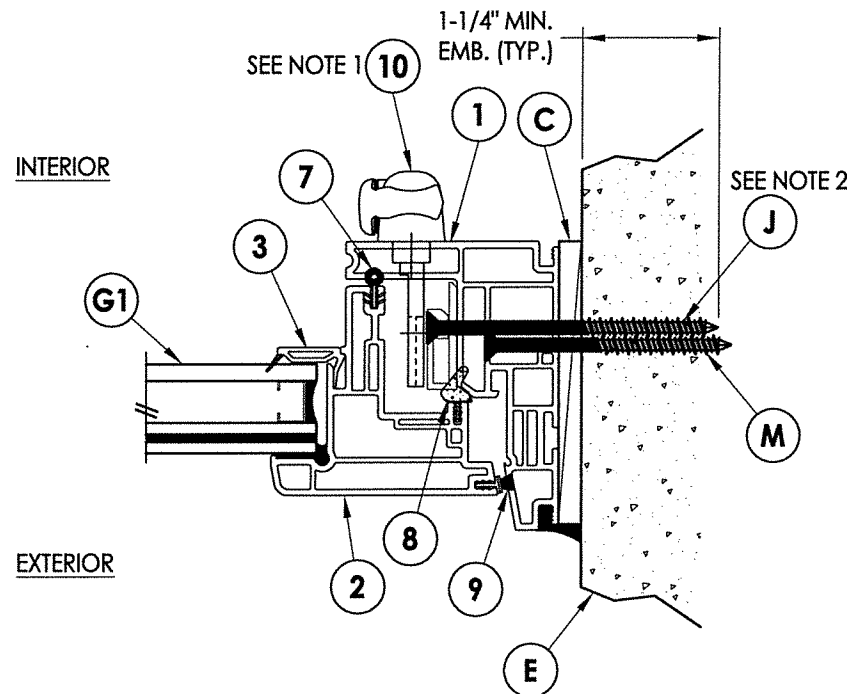

3 HORIZONTAL CROSS SECTION
2 Shown direct to masonry

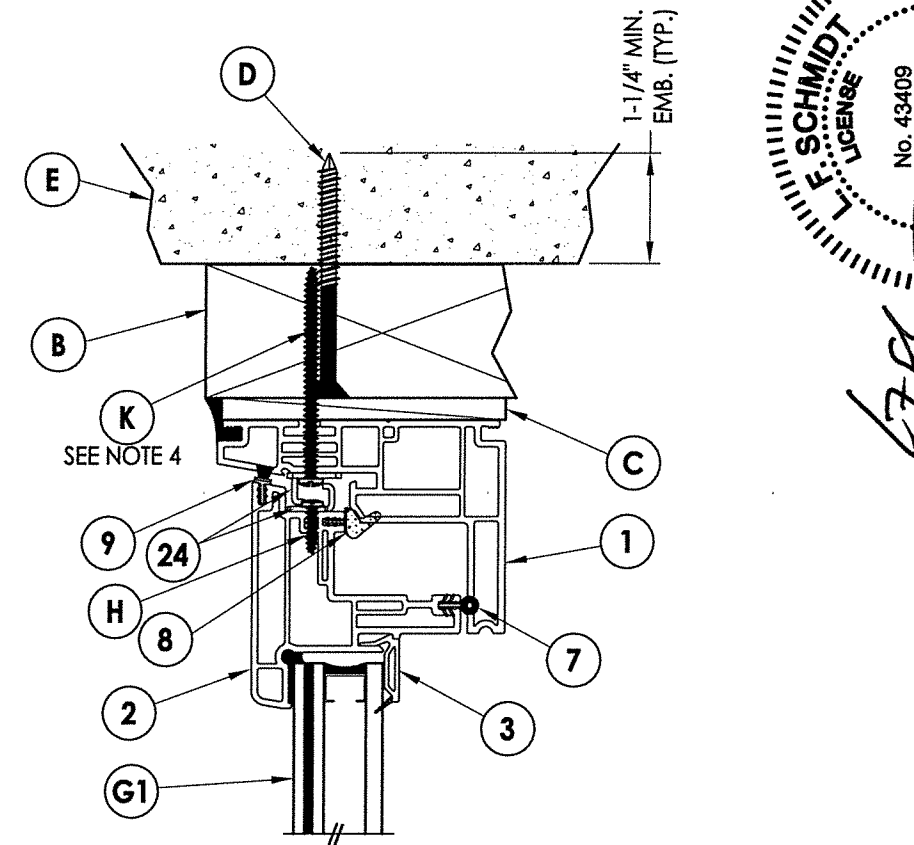

4 VERTICAL CROSS SECTION
2

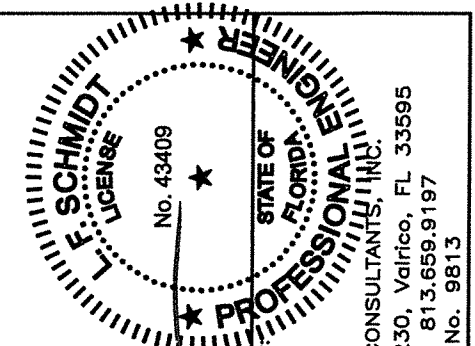

Documents Prepared By:
Lyndon F. Schmidt
P.E. No. 43409

RW
BUILDING CONSULTANTS, INC.
P.O. Box 230, Valrico, FL 33595
Phone No.: 813.659.9197
FBPE C.A. No. 9813

PRODUCT: 8800 SERIES Vinyl Awning Window

PART OR ASSEMBLY: HORIZONTAL CROSS SECTIONS

REVISIONS		NO.	DATE	BY
3	4/11/19	REVISE FOR NEW HARDWARE	LFS	
2	6/01/17	UPDATE TO 6TH ED. (2017)	FBC	LFS
1	1/28/15	UPDATE TO 5TH ED. (2014)	FBC	JK

DATE: 4/04/13
SCALE: N.T.S.
DWG. BY: JK
CHK. BY: LFS
DRAWING NO.: FL-15818.3
SHEET 2 OF 4

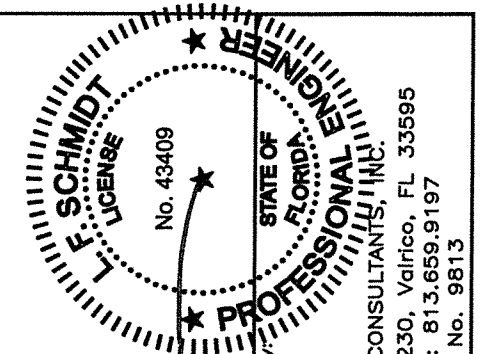
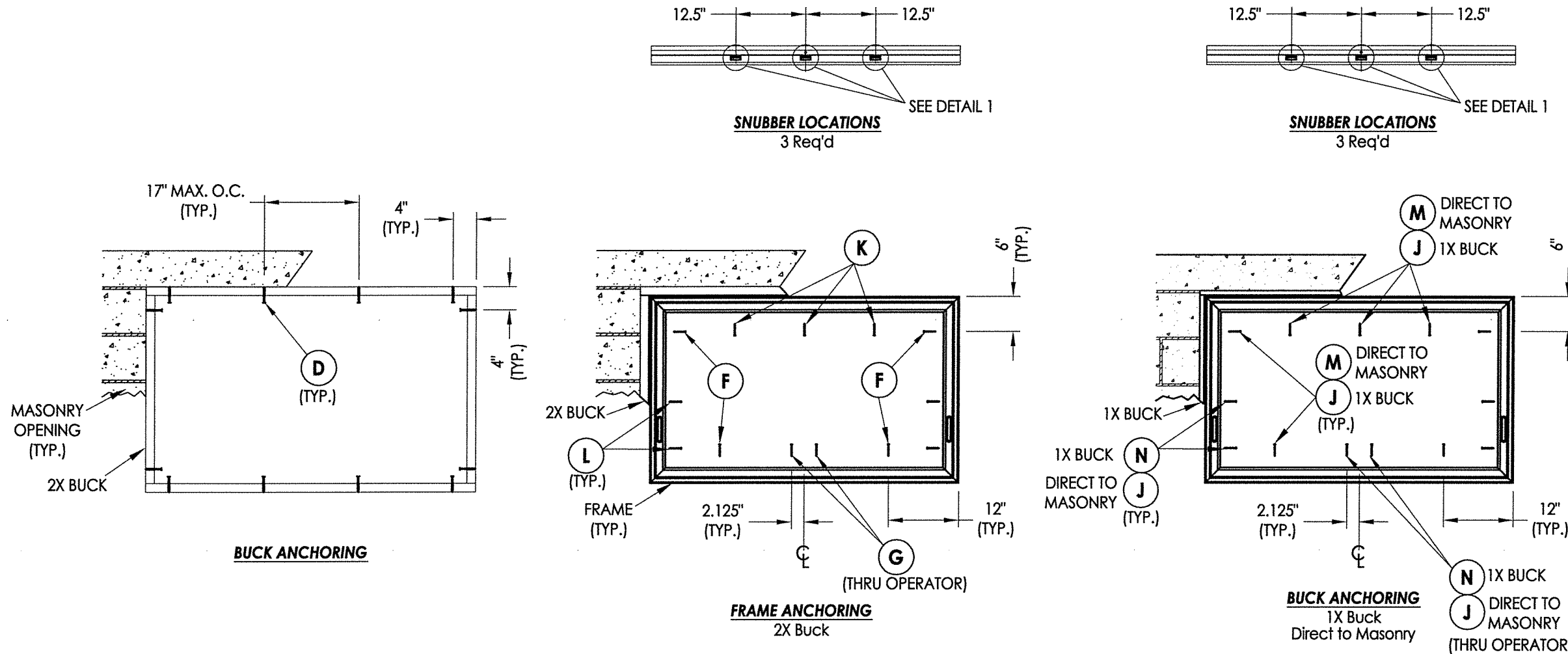

Documents Prepared By:
 Lyndon F. Schmidt
 P.E. No. 43409

R.W.
 BUILDING CONSULTANTS, INC.
 P.O. Box 230, Valrico, FL 33595
 Phone No.: 813.659.9197
 FBPE C.A. No. 9813

PRODUCT: 8800 SERIES Vinyl Awning Window

PART OR ASSEMBLY: BUCK AND FRAME ANCHORING

NO.	DATE	REVISIONS
3	4/11/19	REVISE FOR NEW HARDWARE
2	6/01/17	UPDATE TO 6TH ED. (2017) FBC
1	1/28/15	UPDATE TO 5TH ED. (2014) FBC

DATE: 4/04/13
 SCALE: N.T.S.
 DWG. BY: JK
 CHK. BY: LFS
 DRAWING NO.: FL-15818.3
 SHEET 3 OF 4

CONCRETE ANCHOR NOTES:

- Concrete anchor locations at the corners may be adjusted to maintain the min. edge distance to mortar joints.
- Concrete anchor locations noted as "MAX. ON CENTER" must be adjusted to maintain the min. edge distance to mortar joints, additional concrete anchors may be required to ensure the "MAX. ON CENTER" dimension are not exceeded.
- Concrete anchor table:

ANCHOR TYPE	ANCHOR SIZE	MIN. EMBEDMENT	MIN. CLEARANCE TO MASONRY EDGE	MIN. CLEARANCE TO ADJACENT ANCHOR
ITW TAPCON®	3/16" 1/4"	1-1/4"	2"	4"
ELCO ULTRACON®	3/16" 1/4"	1-1/4"	1"	4"

WOOD SCREW INSTALLATION NOTES:

- Maintain a minimum 5/8" edge distance, 1" end distance, & 1" o.c. spacing of wood screws to prevent the splitting of wood.

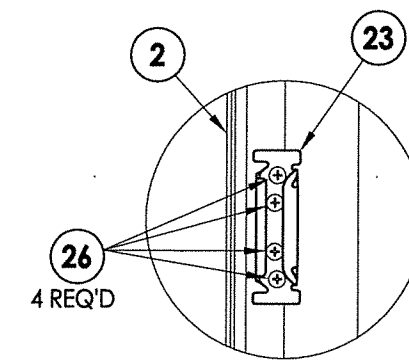
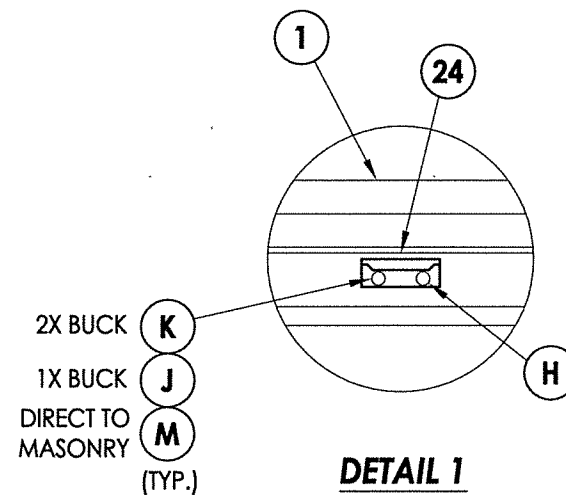

BILL OF MATERIALS		
ITEM #	DESCRIPTION	MATERIAL
A	1X BUCK (SG >= 0.55)	WOOD
B	2X BUCK (SG >= 0.55)	WOOD
C	1/4" MAX. SHIM SPACE	-
D	1/4" X 2-3/4" PFH ELCO OR ITW CONCRETE SCREW	STEEL
E	MASONRY - 3,000 PSI MIN. CONCRETE CONFORMING TO ACI 301 OR HOLLOW BLOCK CONFORMING TO ASTM C90	CONCRETE
F	#8 X 2-1/2" MODIFIED TRUSS HEAD (7/16" Ø) SMS (1-3/8" MIN. EMBEDMENT)	STEEL
G	#8 X 2-1/2" PFH WOOD SCREW (7/8" MIN. EMB.)	STEEL
H	#8 X 1/2" PPH SMS	STEEL
J	3/16" X 3-1/4" PFH ELCO OR ITW CONCRETE SCREW	STEEL
K	#8 X 2-1/2" PPH WOOD SCREW (1-1/2" MIN. EMB.)	STEEL
L	#8 X 3" PFH SMS (1-5/16" MIN. EMB.)	STEEL
M	3/16" X 2-3/4" PFH ELCO OR ITW CONCRETE SCREW	STEEL
N	3/16" X 3-3/4" PFH ELCO OR ITW CONCRETE SCREW	STEEL
1	FRAME*	PVC
2	SASH*	PVC
3	GLAZING BEAD*	PVC
7	WEATHERSTRIP AMESBURY (CS 120 33-SEAL)	FOAM
8	WEATHERSTRIP AMESBURY (12300 SEAL)	VINYL
9	WEATHERSTRIP ULTRA FAB .250 (PILE - 250 - KP52)	VINYL
10	MULTI-POINT LOCK (TRUTH) 24.33.32.004	-
11	TIE BAR GUIDE (TRUTH)	-
12	OPERATOR (TRUTH) 50.10.00.011	-
23	KEEPER (TRUTH)	STEEL
24	SNUBBER (TRUTH) (SASH/FRAME) 22999	-
26	#8 X 1/2" PFH SMS	STEEL

* THE APPROVED WHITE RIGID PVC EXTERIOR EXTRUSIONS FOR WINDOWS ARE TO BE PRODUCED BY EXTRUDERS LICENSEES IN "AAMA CERTIFICATION PROGRAMS FOR RIGID PVC EXTRUSIONS".

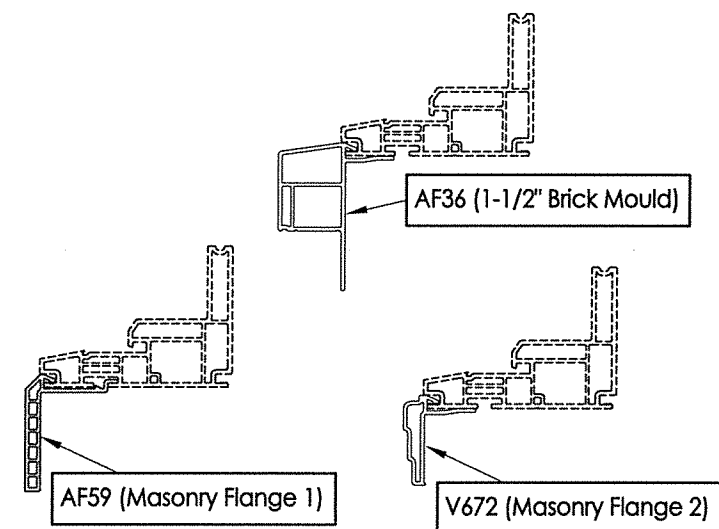
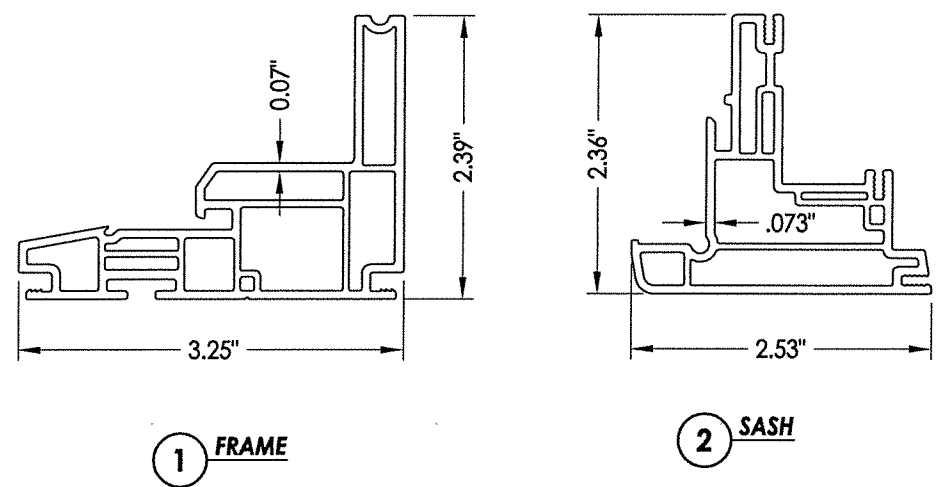

OPTIONAL COSMETIC FLANGES

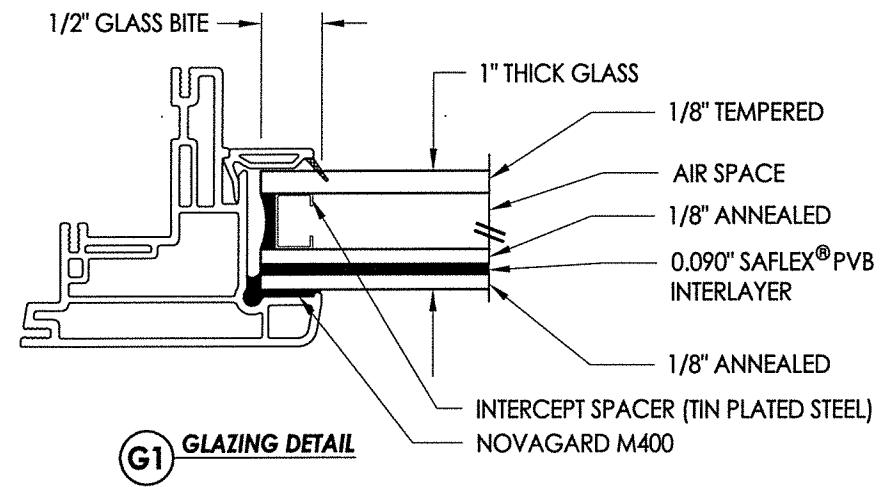

G1 GLAZING DETAIL

NOTE: GLAZING > 36" WIDE REQUIRES TWO (2) SETTING BLOCKS CONFORMING TO FBC SECTION 2411.3.3.1.

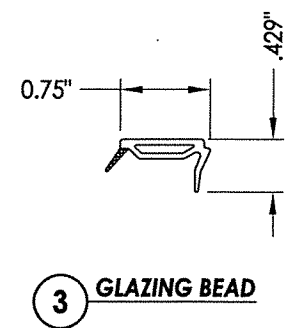

3 GLAZING BEAD

Documents Prepared By: **Lyndon F. Schmidt**
 P.E. No. 43409
 Date: **4.17.19**

R.W. BUILDING CONSULTANTS, INC.
 P.O. Box 230, Valrico, FL 33595
 Phone No.: 813.659.9197
 FBPE C.A. No. 9813

PRODUCT: 8800 SERIES Vinyl Awning Window	
PART OR ASSEMBLY: BILL OF MATERIALS, COMPONENTS AND GLAZING DETAIL	
NO.	DATE
3	4/11/19 REVISE FOR NEW HARDWARE
2	6/01/17 UPDATE TO 6TH ED. (2017) FBC
1	1/28/15 UPDATE TO 5TH ED. (2014) FBC
NO.	DATE
DATE:	4/04/13
SCALE:	N.T.S.
DWG. BY:	JK
CHK. BY:	LFS
DRAWING NO.:	FL-15818.3
SHEET	4 OF 4