



250 Staunton Turnpike, Parkersburg, WV 26104

WINCORE FIBERGLASS ENTRY DOOR INSWING / OUTSWING "IMPACT"

GENERAL NOTES

- This product has been evaluated and is in compliance with the 2010 Florida Building Code (FBC) structural requirements including the "High Velocity Hurricane Zone" (HVHZ).
- Product anchors shall be as listed and spaced as shown on details. Anchor embedment to base material shall be beyond wall dressing or stucco.
- When used in the "HVHZ" this product complies with Section 1626 of the Florida Building Code and does not require an impact resistant covering.
- When used in areas outside of the "HVHZ" requiring wind borne debris protection this product complies with Section 1609.1.2 of the 2010 FBC and does not require an impact resistant covering. This product meets missile level "D" and includes Wind Zone 4 as defined in ASTM E 1996 and Section 1609.1.2.4 of the FBC.
- For 2x stud construction, anchoring of these units shall be the same as that shown for 2x buck masonry construction.
- Site conditions that deviate from the details of this drawing require further engineering analysis by a licensed engineer or registered architect.
- Outswing configurations meet water infiltration requirements for "HVHZ". All other configurations do not meet the water infiltration requirements for the "HVHZ" and must be installed only in non-habitable areas or at habitable locations protected by an overhang or canopy such that the angle between the edge of canopy or overhang to sill is less than 45 degrees.

TABLE OF CONTENTS

SHEET#	DESCRIPTION
1	Typical elevations, design pressures & general notes
2	Door panel details
3	Sidelite panel details
4	Elevations
5	Horizontal cross sections
6	Vertical cross sections
7	3-Point lock details
8	3-Point lock details
9	Buck and frame anchoring (XX)
10	Buck and frame anchoring (OXXO)
11	Astragal details
12	Bill of materials & components

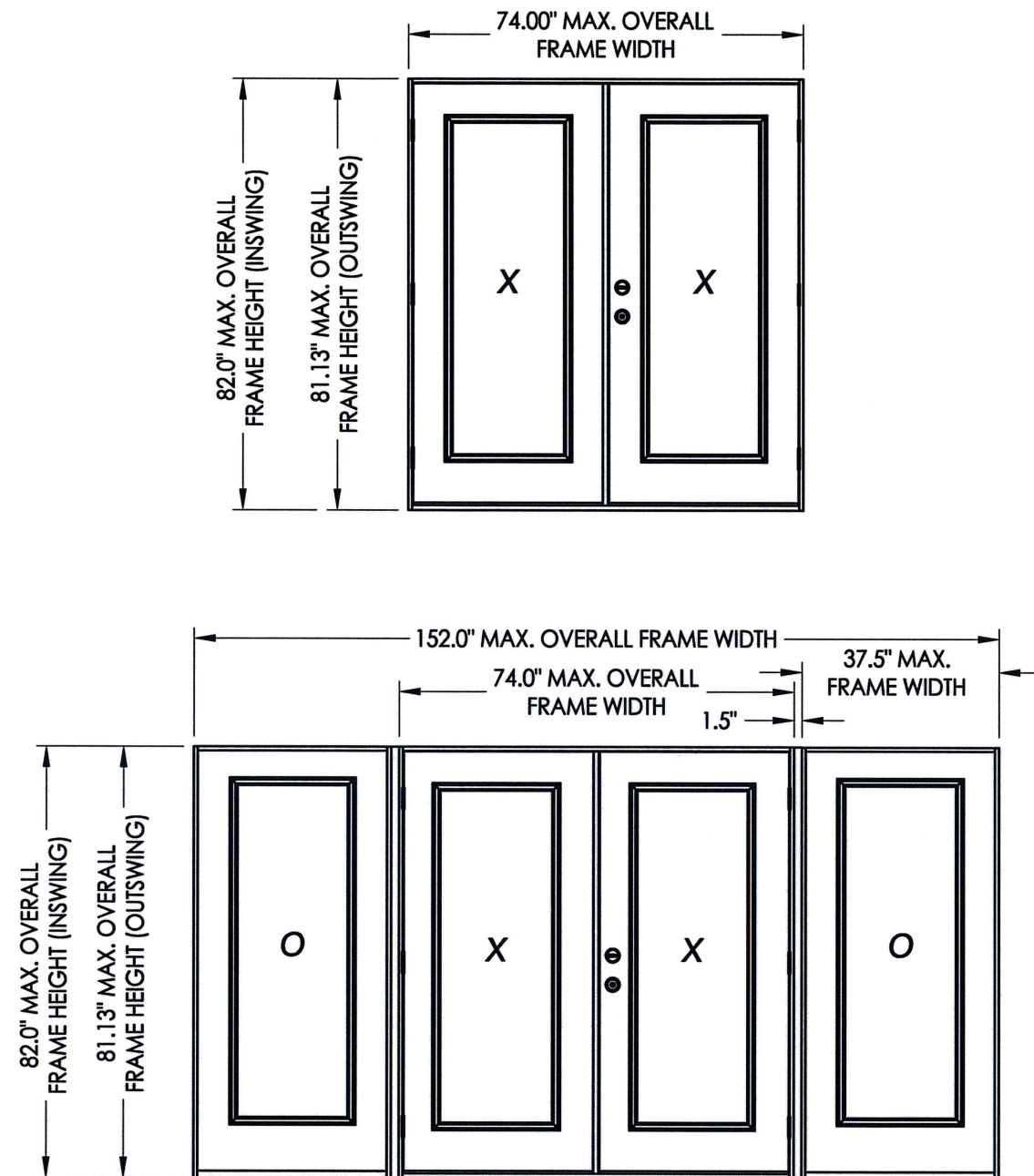

CONFIGURATION	MAX. FRAME DIMENSION	DESIGN PRESSURE (PSF) INSWING		DESIGN PRESSURE (PSF) OUTSWING	
		POSITIVE	NEGATIVE	POSITIVE	NEGATIVE
XX	74.0" x 82.0"	+60.0	-60.0	+75.0	-75.0
OXXO	152.0" x 82.0"	+50.0	-50.0	+50.0	-50.0

See sheet 2 for hardware design pressure limitations

Documents Prepared By:

RW BUILDING CONSULTANTS, INC.
P.O. Box 230 Vairico FL 33595
Phone No.: 813.659.9197
Florida Board of Professional Engineers
Certificate of Authorization No. 9813
Lyndon F. Schmidt, P.E. No. 43409

PRODUCT: WINCORE FIBERGLASS DOOR
PART OR ASSEMBLY: TYPICAL ELEVATION, DESIGN PRESSURES & GENERAL NOTES

NO.	DATE	BY	REVISIONS

DATE: 05/10/12
SCALE: N.T.S.
DWG. BY: JK
CHK. BY: LFS
DRAWING NO.: FL-15631.6
SHEET 1 OF 12

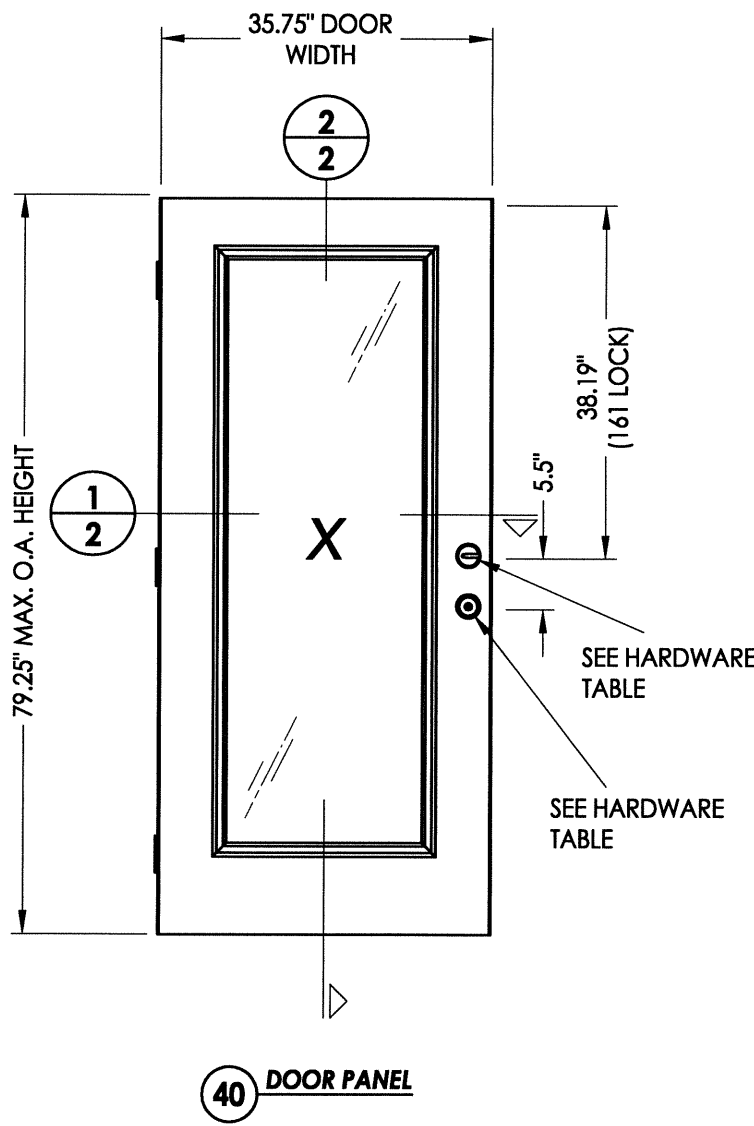
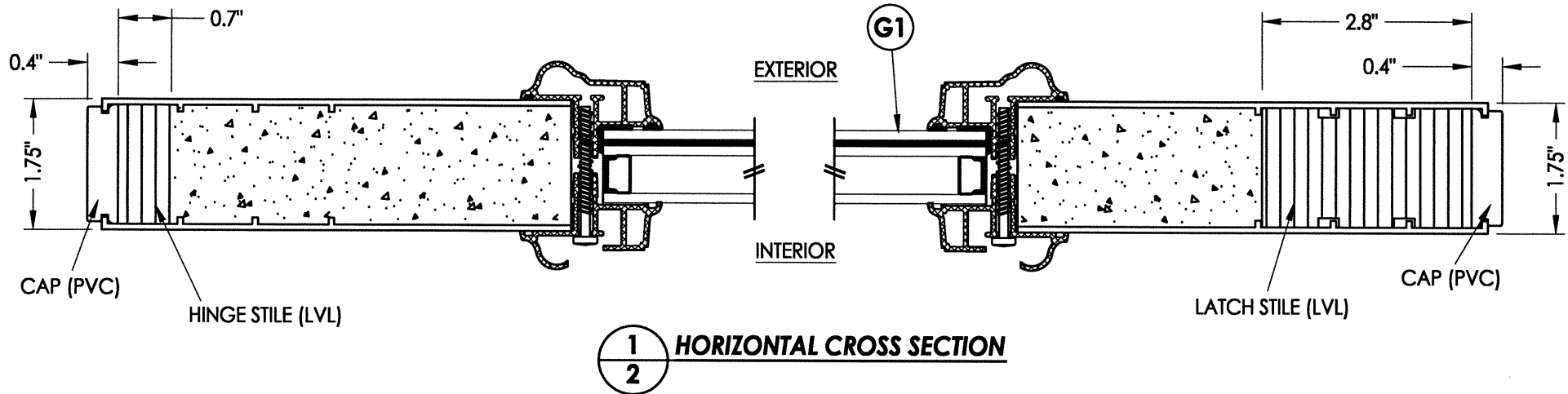

HARDWARE TABLE			
MANUFACTURER	MODEL		MAX. DESIGN PRESSURE (PSF)
KWIKSET	KNOB:	SIGNATURE SERIES	±75
	DEADBOLT:	SIGNATURE SERIES (980)	
SCHLAGE	KNOB:	"F" SERIES (F51)	± 75
	DEADBOLT:	"B" SERIES (B60/62)	
PAMEX	LEVER:	FL3B SERIES	± 75
	DEADBOLT:	FD7 SERIES	
HOPPE	MULTI-POINT LOCK:	3-POINT TONGUE	± 50
W & F	MULTI-POINT LOCK:	TRILENNIUM "3000" SERIES	± 75

See sheets 7 and 8 for multi-point lock details.

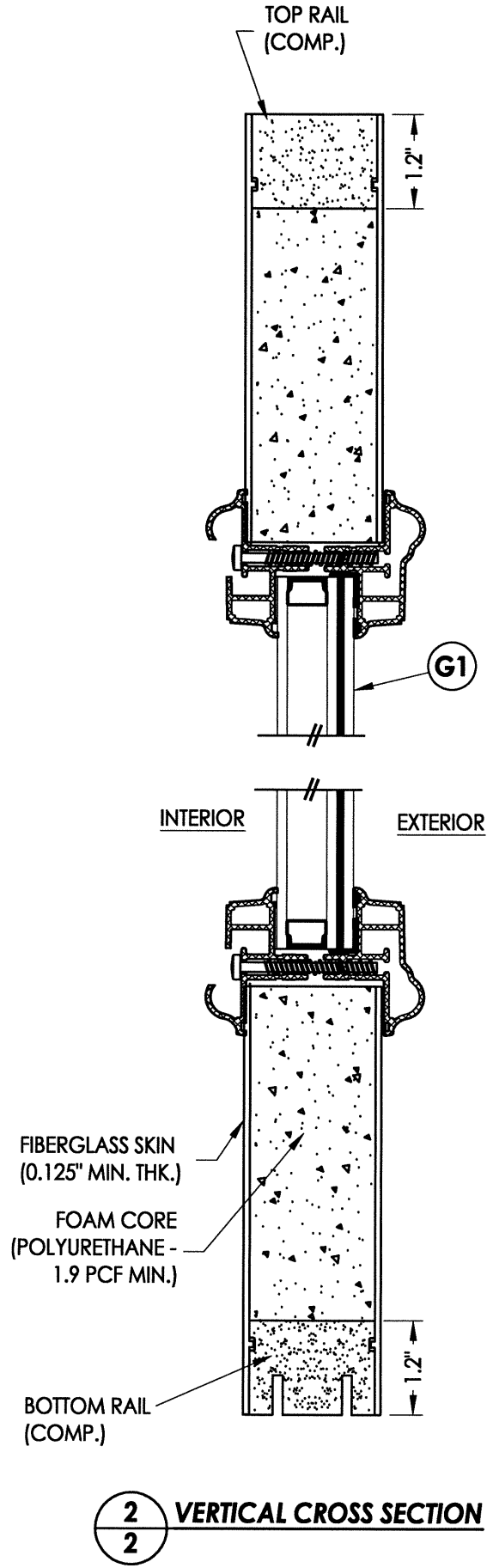

Documents Prepared By:
RW BUILDING CONSULTANTS, INC.
 P.O. Box 230 Valrico FL 33595
 Phone No.: 813.659.9197
 Florida Board of Professional Engineers
 Certificate Of Authorization No. 9813
LFS S.A.R.
 Lyndon F. Schmidt, P.E. No. 43409

PRODUCT: WINCORE FIBERGLASS DOOR
 PART OR ASSEMBLY: DOOR PANEL DETAILS

NO.	DATE	BY	REVISIONS

DATE: 05/10/12
 SCALE: N.T.S.
 DWG. BY: JK
 CHK. BY: LFS
 DRAWING NO.: FL-15631.6
 SHEET 2 OF 12

© 2012 R.W. BUILDING CONSULTANTS INC.

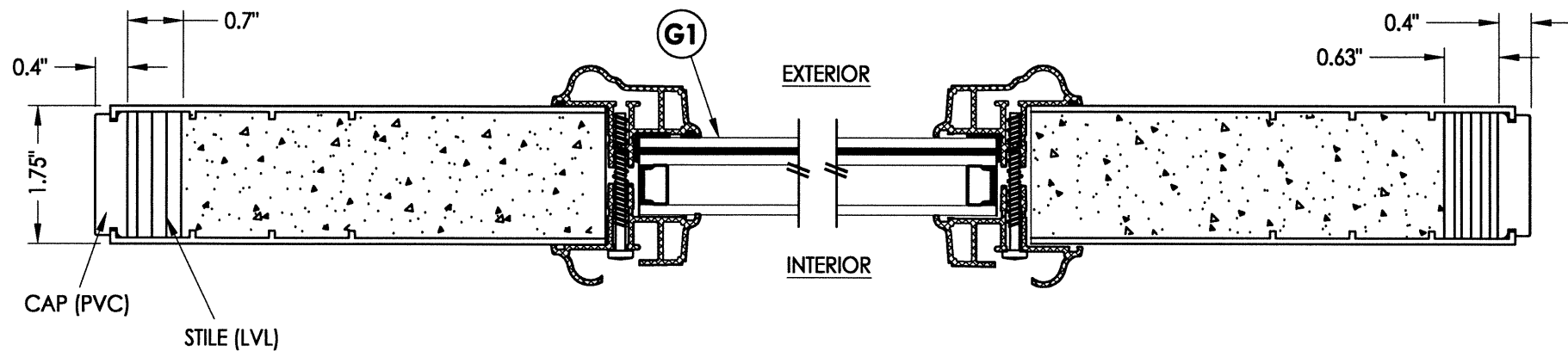

1
3 HORIZONTAL CROSS SECTION

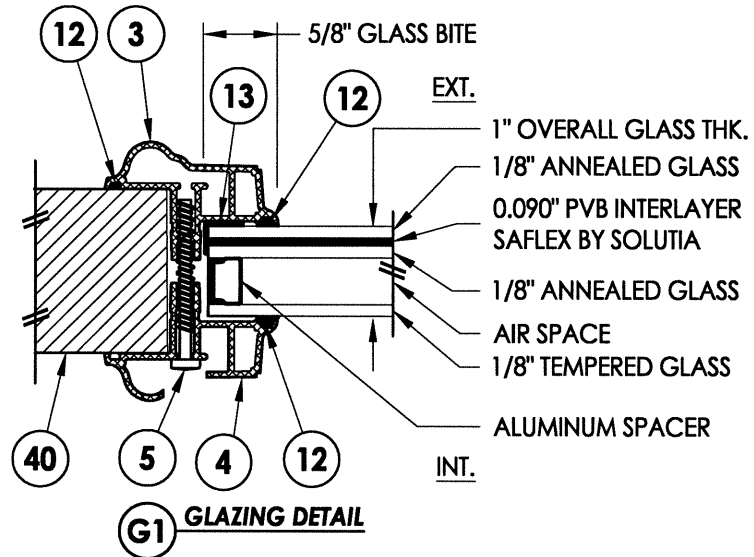

G1 GLAZING DETAIL

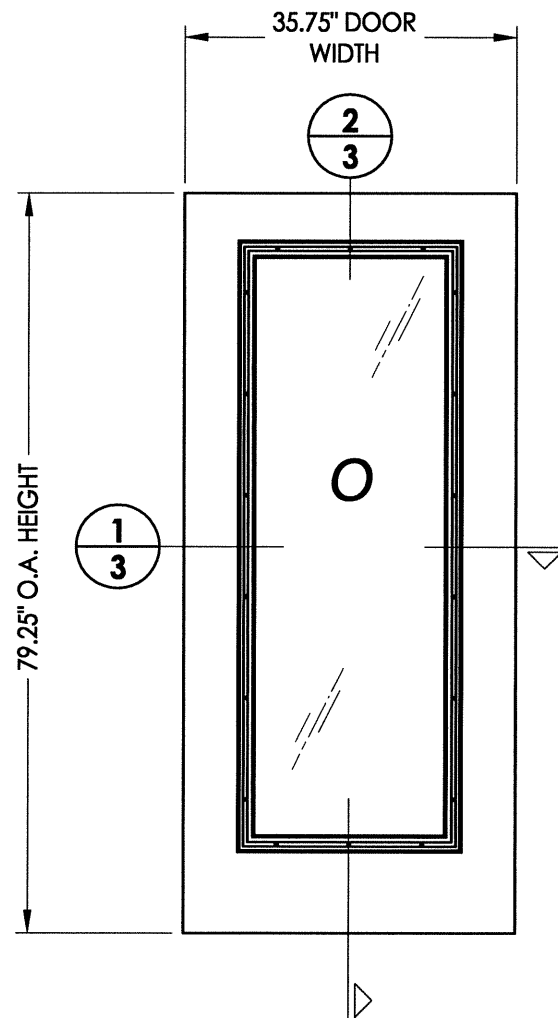

50 SIDELITE PANEL

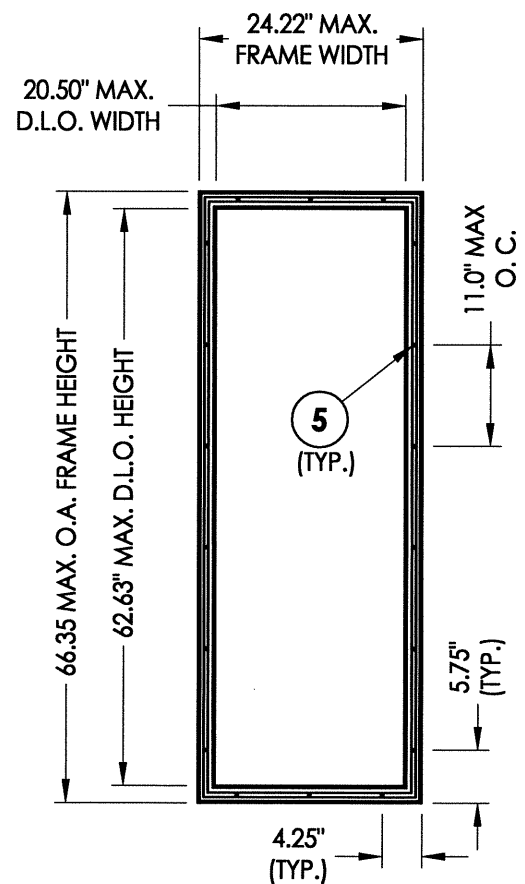

5 (TYP.)
ODL LITE FRAME

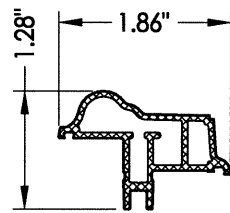

3 EXT. FRAME

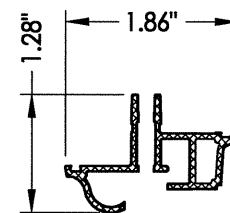

4 INT. FRAME

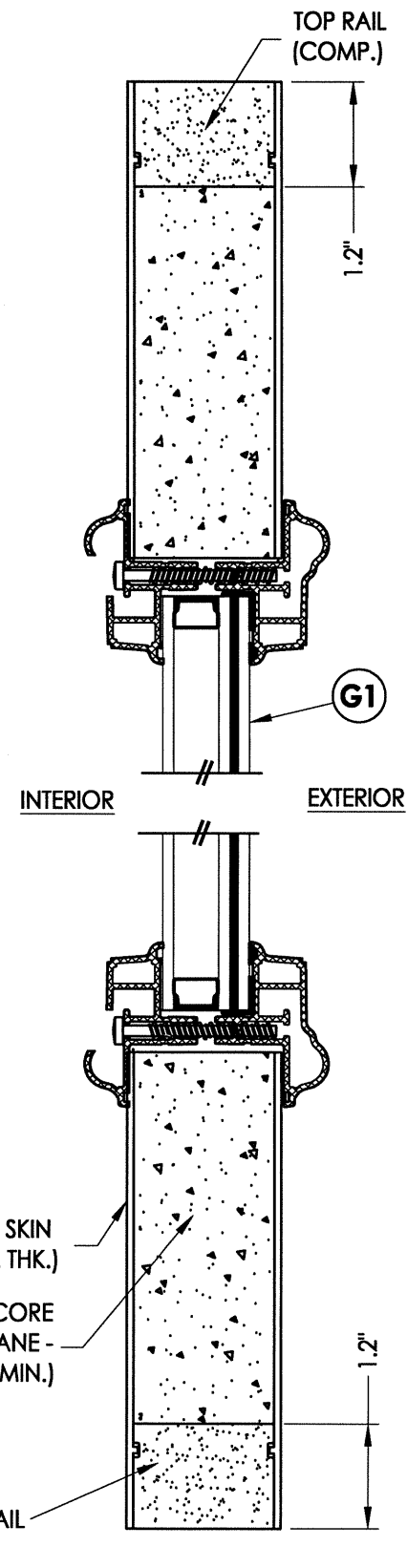

2
3 VERTICAL CROSS SECTION

PRODUCT:	WINCORE FIBERGLASS DOOR
PART OR ASSEMBLY:	SIDELITE PANEL DETAILS

NO.	DATE	BY	REVISIONS

DATE:	05/10/12
SCALE:	N.T.S.
DWG. BY:	JK
CHK. BY:	LFS
DRAWING NO.:	FL-15631.6
SHEET	3 OF 12

Documents Prepared By:
RW BUILDING CONSULTANTS, INC.
 P.O. Box 230 Valrico FL 33595
 Phone No.: 813.659.9197
 Florida Board of Professional Engineers
 Certificate of Authorization No. 9813
LFS
 Lyndon F. Schmidt, P.E. No. 43409

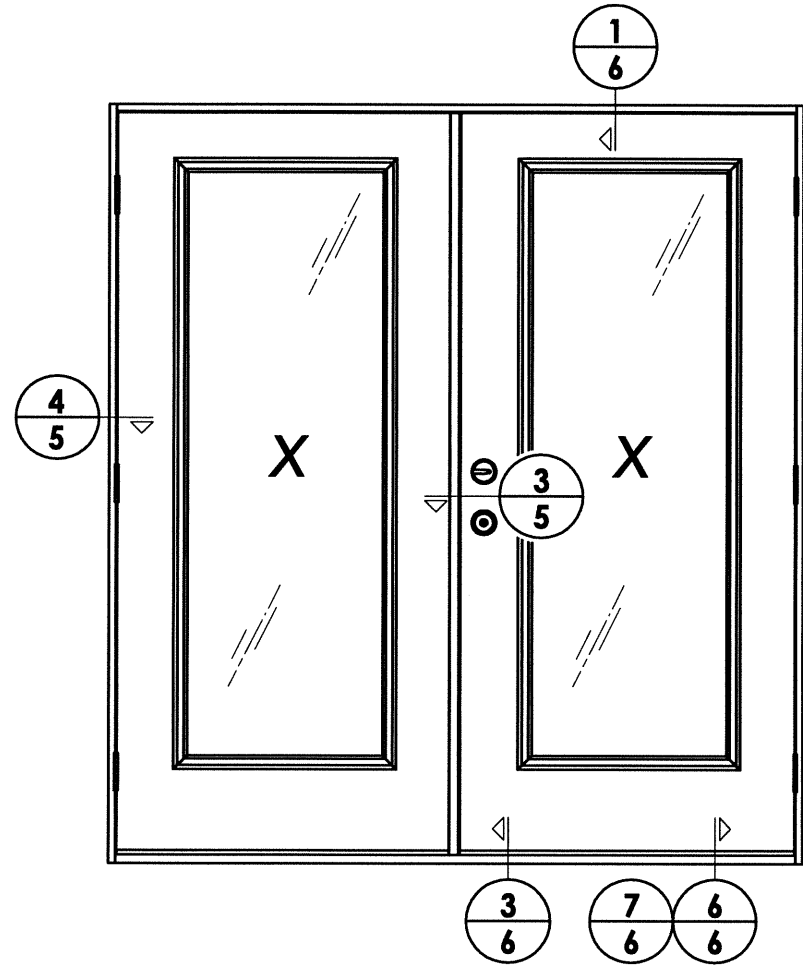

ELEVATION (XX)

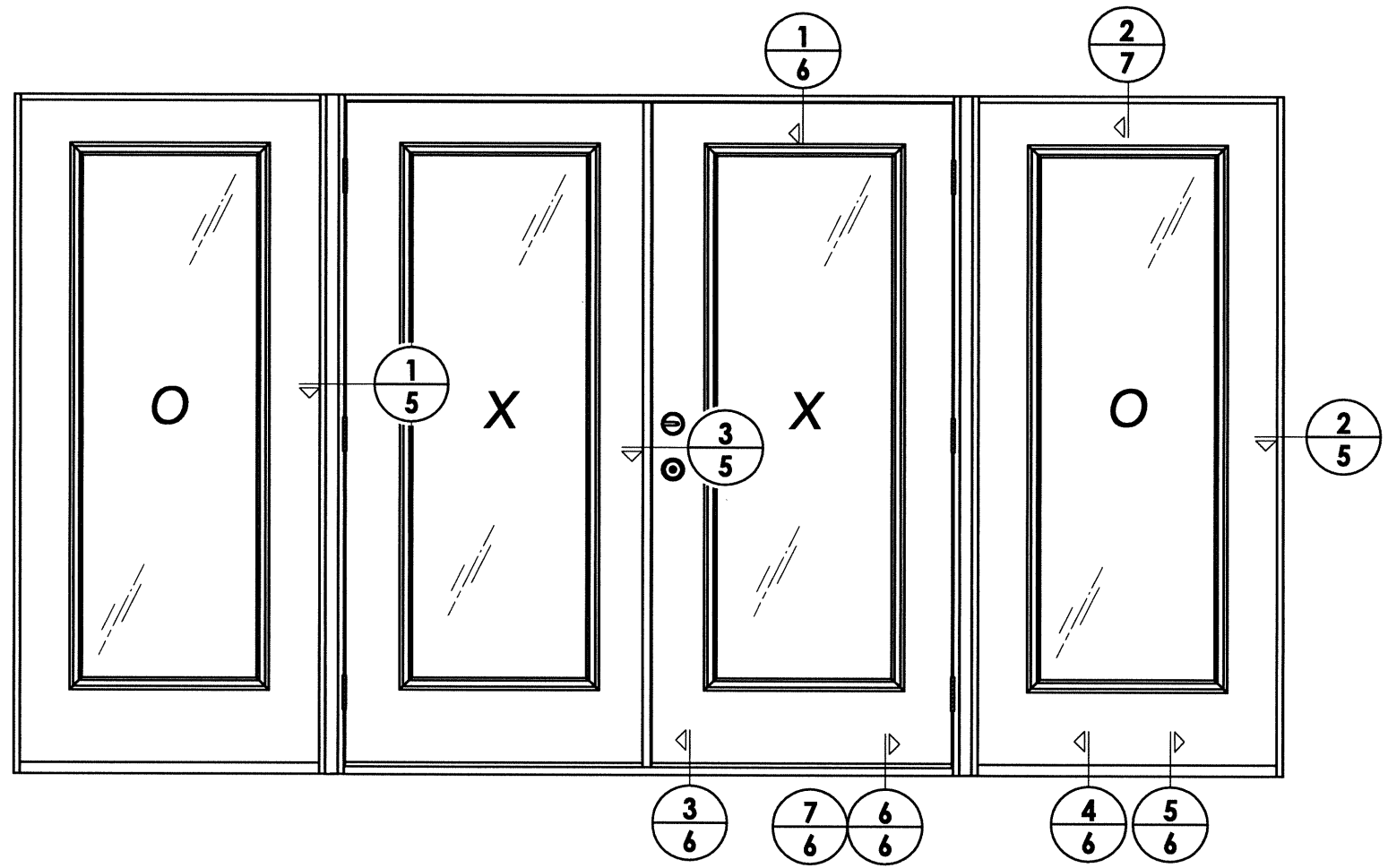

ELEVATION (OXXO)

PRODUCT: WINCORE FIBERGLASS DOOR
 PART OR ASSEMBLY: ELEVATIONS

NO.	DATE	BY

DATE: 05/10/12
 SCALE: N.T.S.
 DWG. BY: JK
 CHK. BY: LFS
 DRAWING NO.: FL-15631.6
 SHEET 4 OF 12

Documents Prepared By:
RW BUILDING CONSULTANTS, INC.
 P.O. Box 230 Valrico FL 33595
 Phone No.: 813.659.9197
 Florida Board of Professional Engineers
 Certificate Of Authorization No. 9813
LFS 5.31.12
 Lyndon F. Schmidt, P.E. No. 43409

NOTE:

1. Spacing for item K: 6" from ends and 7 more equally spaced along sidelite (9 total).

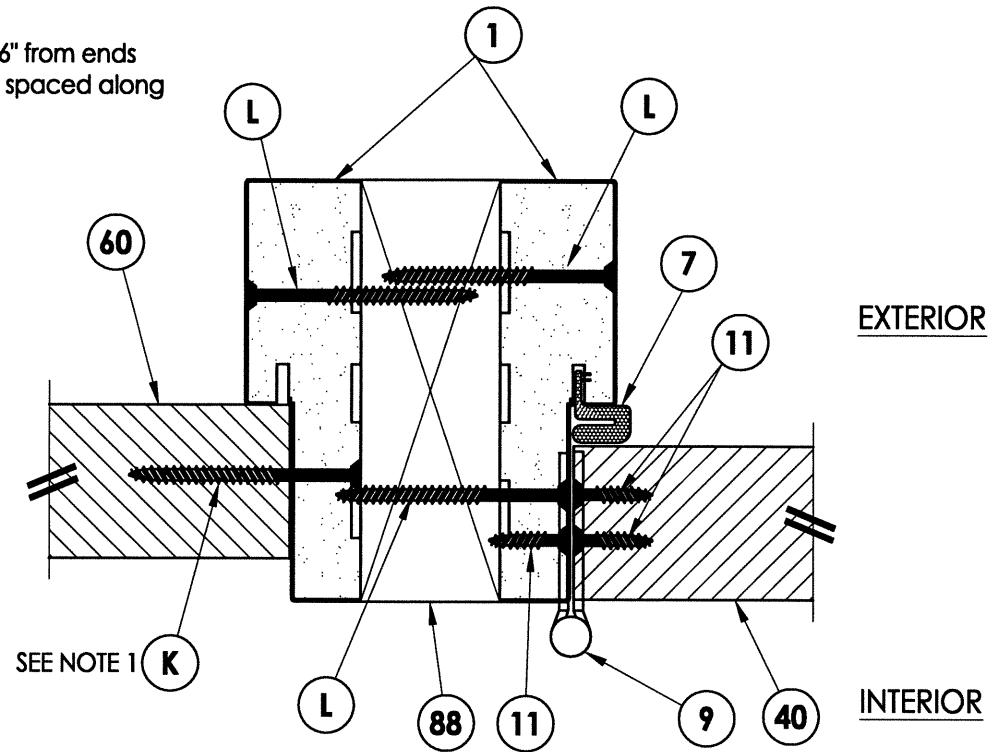

1 HORIZONTAL CROSS SECTION
5 Inswing shown - outswing also approved

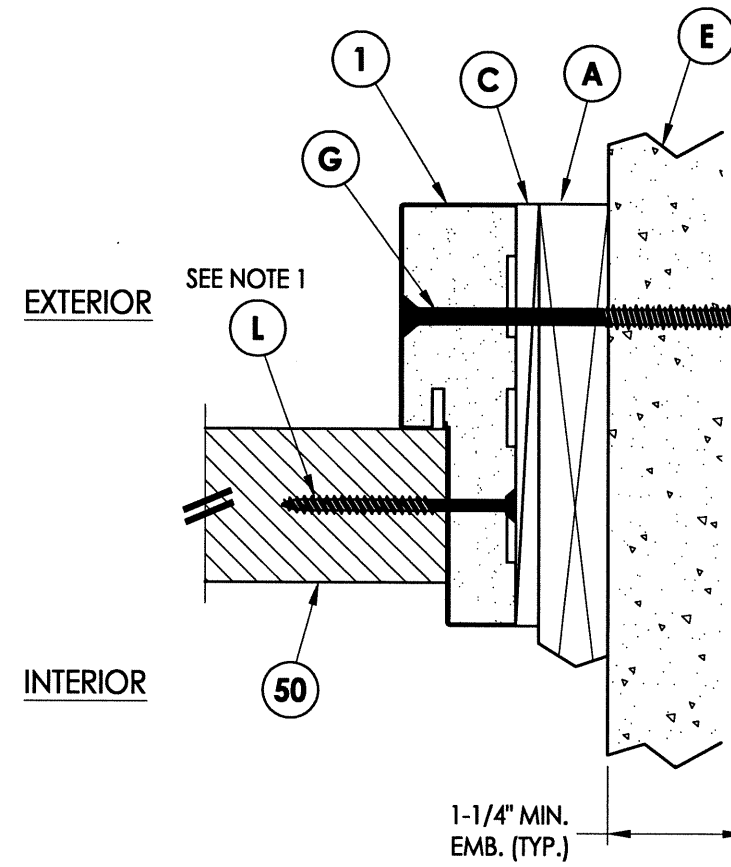

2 HORIZONTAL CROSS SECTION
5 Shown w/1X sub-buck

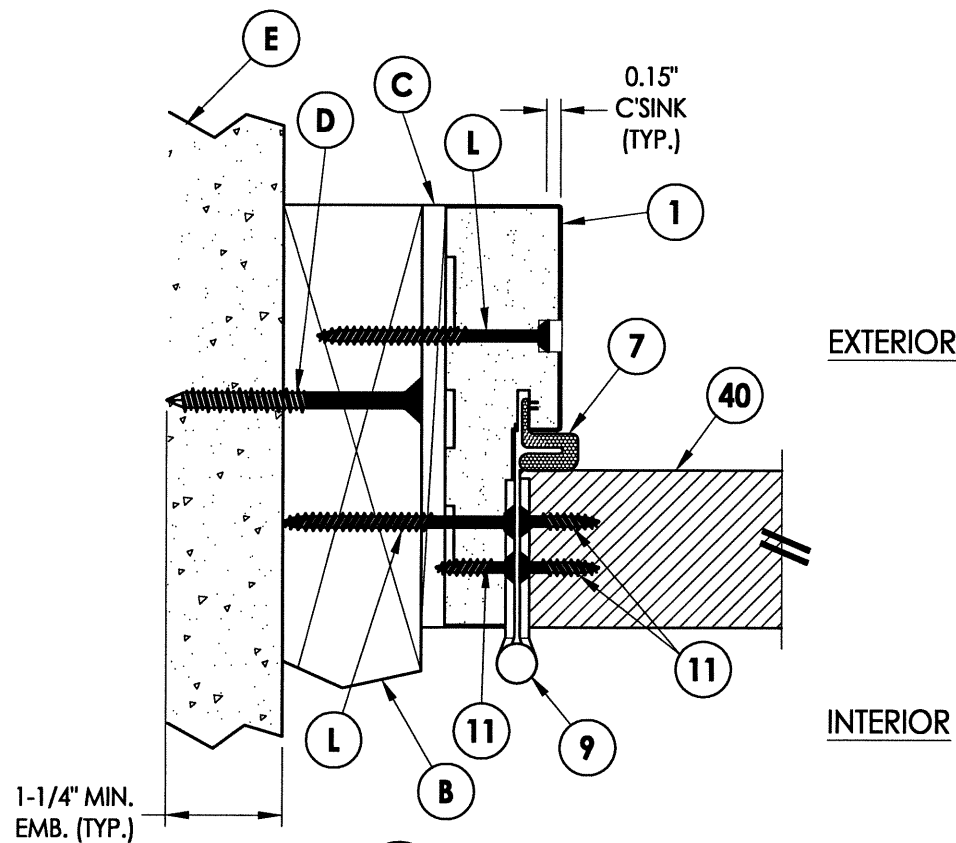

4 HORIZONTAL CROSS SECTION
5 Inswing shown - outswing also approved

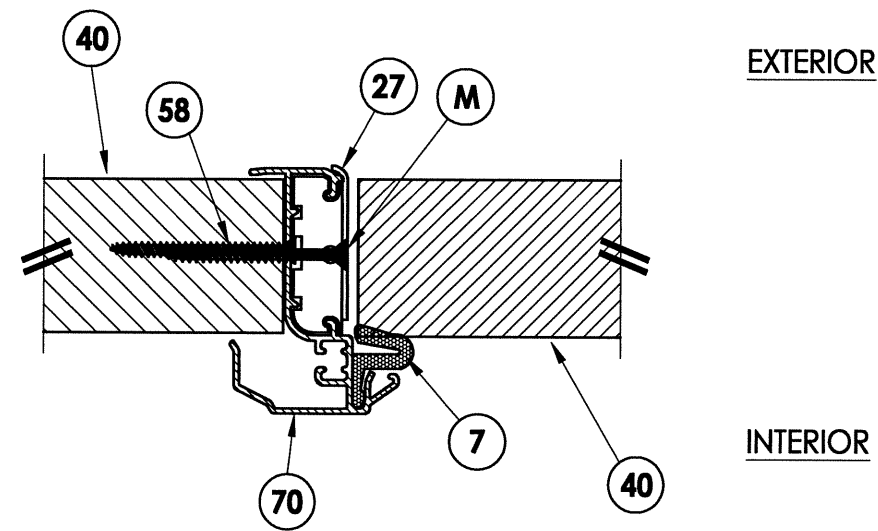

3 HORIZONTAL CROSS SECTION
5 Outswing shown - inswing also approved

Documents Prepared By:

RW BUILDING CONSULTANTS, INC.
P.O. Box 230 Valrico FL 33595
Phone No.: 813.659.9197
Florida Board of Professional Engineers
Certificate Of Authorization No. 9813
LFS
Lyndon F. Schmidt, P.E. No. 43409

PRODUCT: WINCORE FIBERGLASS DOOR

PART OR ASSEMBLY: HORIZONTAL CROSS SECTIONS

NO.	DATE	BY

DATE: 05/10/12
SCALE: N.T.S.
DWG. BY: JK
CHK. BY: LFS
DRAWING NO.: FL-15631.6
SHEET 5 OF 12

R:\A - Projects\Project Folders\Proj 1601 - 1700\PF 1671\1D. RWBC Drawings\FL-15631.dwg, 6.6

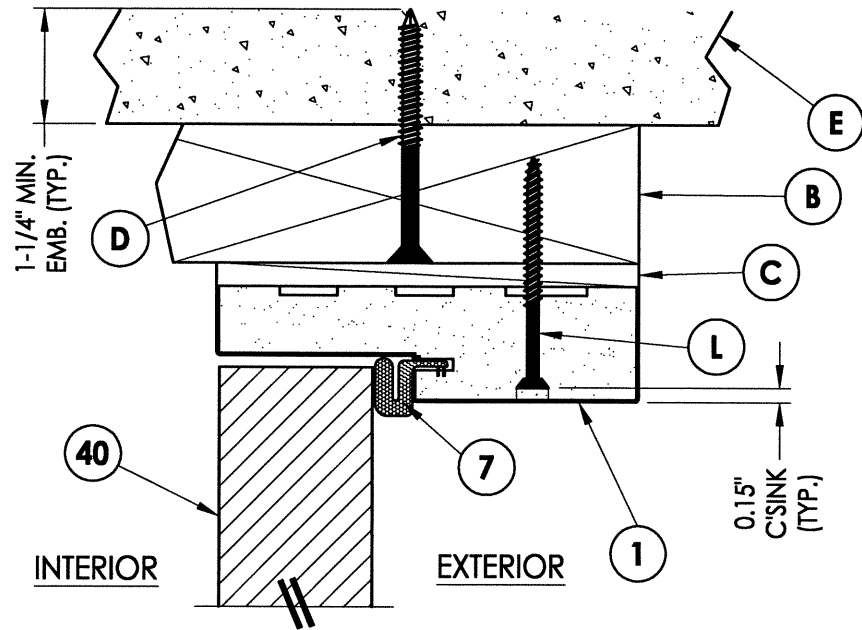

1 VERTICAL CROSS SECTION
6 Inswing shown - outswing also approved

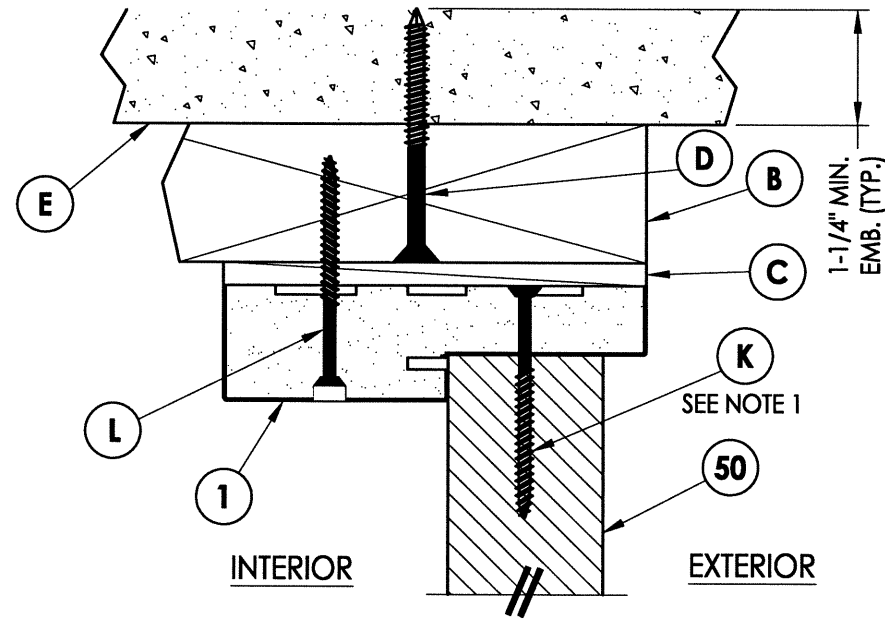

2 VERTICAL CROSS SECTION
6 Outswing shown - inswing also approved

NOTE

1. Spacing for item K:
6" from each end
and at centerline.

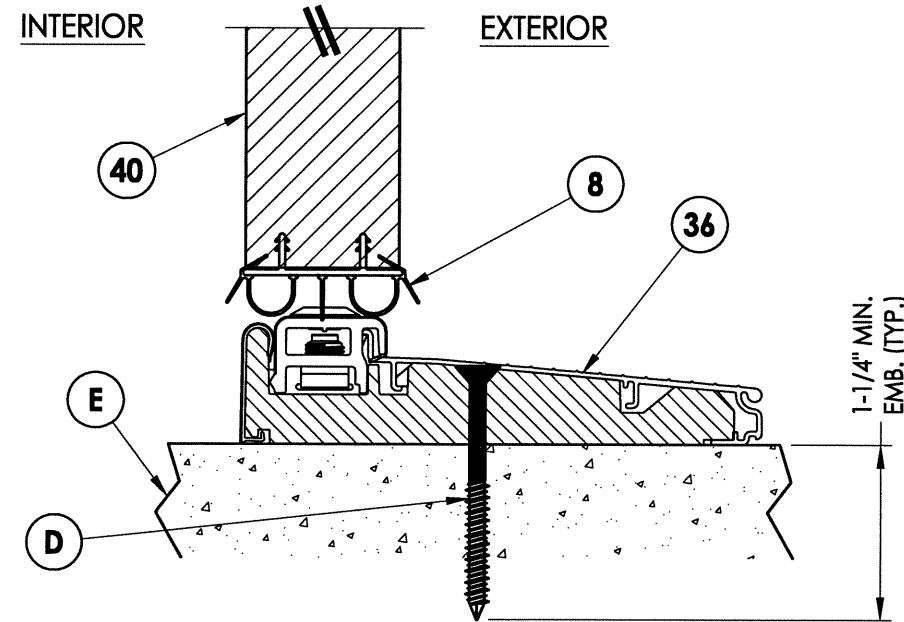

3 VERTICAL CROSS SECTION
6 Inswing shown

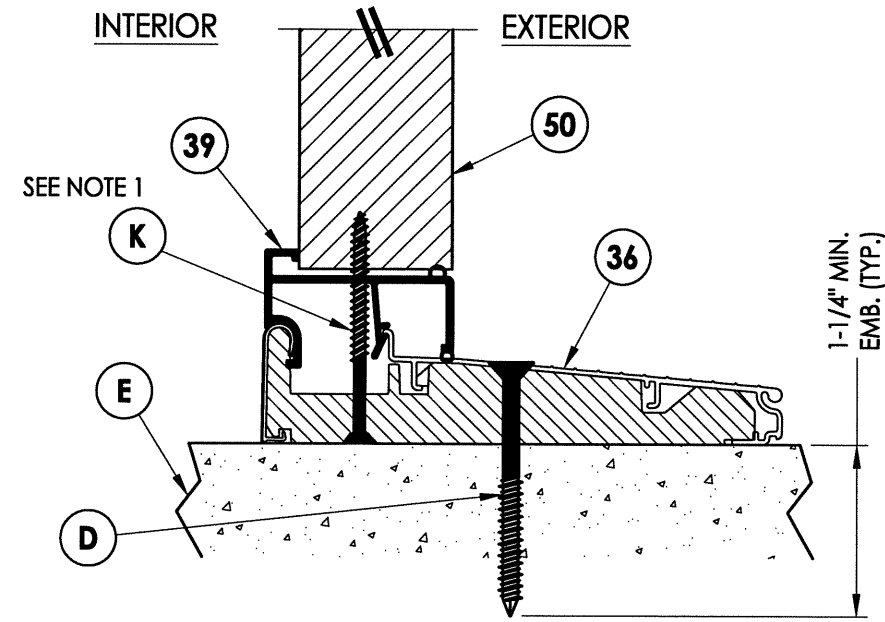

4 VERTICAL CROSS SECTION
6 Inswing shown

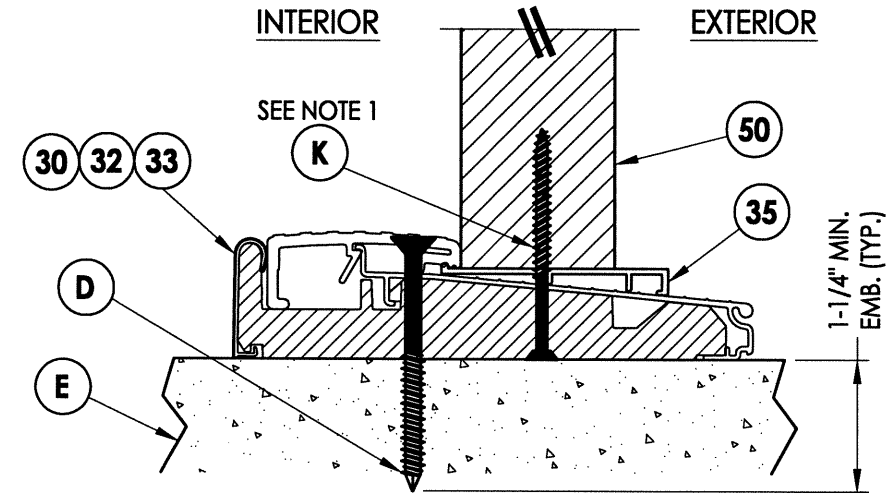

5 VERTICAL CROSS SECTION
6 Outswing shown

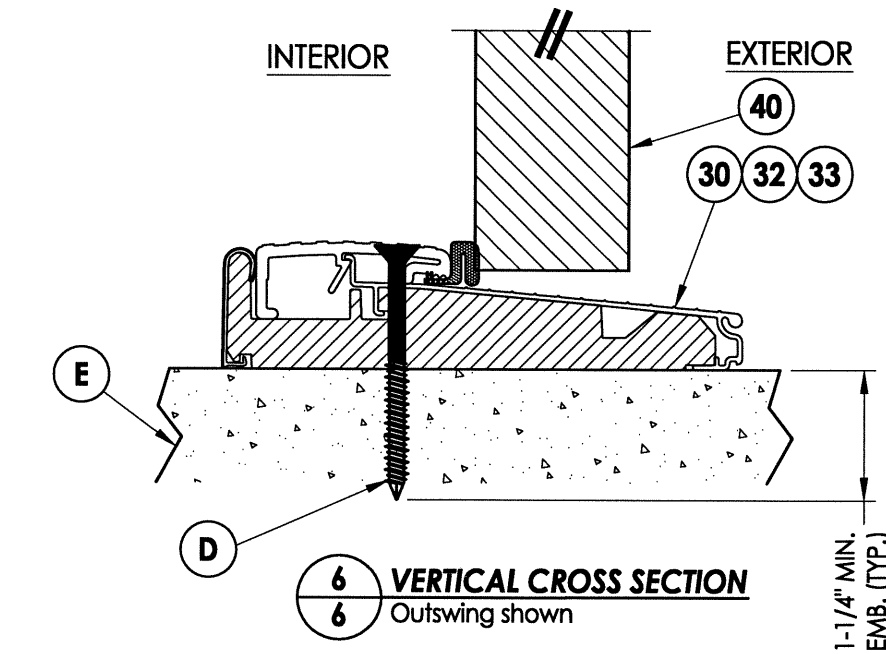

6 VERTICAL CROSS SECTION
6 Outswing shown

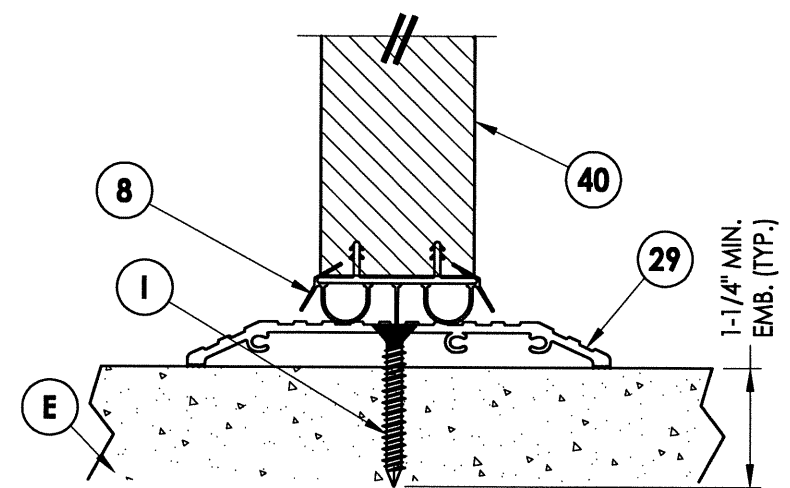

7 VERTICAL CROSS SECTION
6 Shown w/ ADA threshold

Documents Prepared By:
RW BUILDING CONSULTANTS, INC.
P.O. Box 230 Valrico FL 33595
Phone No.: 813.659.9197
Florida Board of Professional Engineers
Certificate of Authorization No. 9813
LFS S-3112
Lyndon F. Schmidt, P.E. No. 43409

PRODUCT: WINCORE FIBERGLASS DOOR
PART OR ASSEMBLY: VERTICAL CROSS SECTIONS

NO.	DATE	BY	REVISIONS

DATE: 05/10/12
SCALE: N.T.S.
DWG. BY: JK
CHK. BY: LFS
DRAWING NO.: FL-15631.6
SHEET 6 OF 12

R:\VA - Projects\Project Folders\Proj 1601 - 1700\PF 1671\D. RWBC Drawings\FL-15631.dwg, 7.6

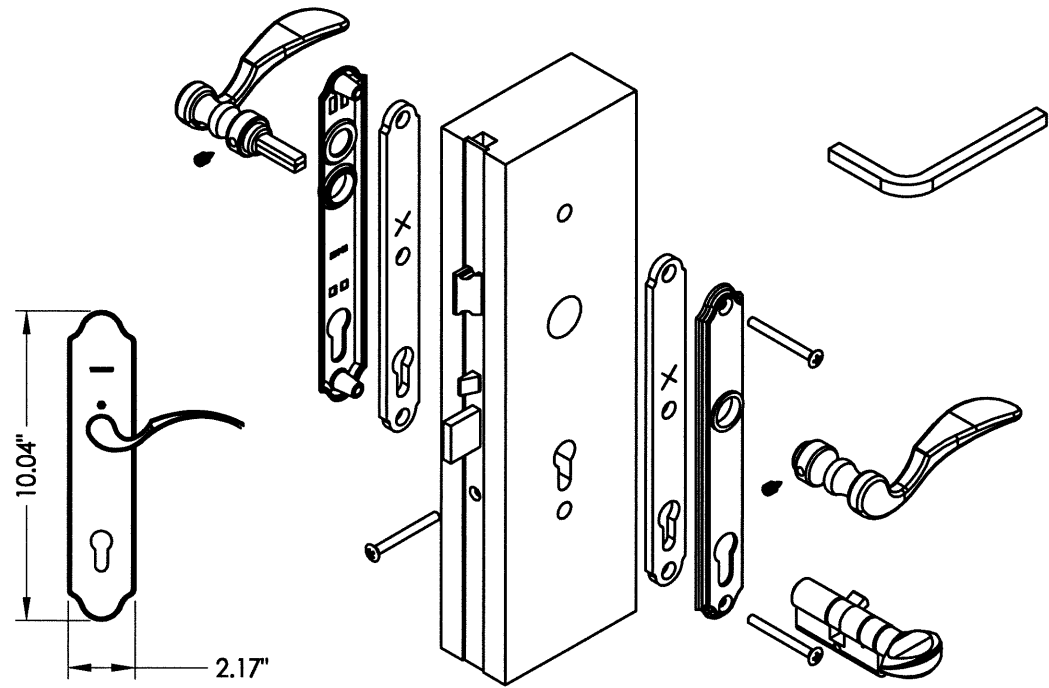
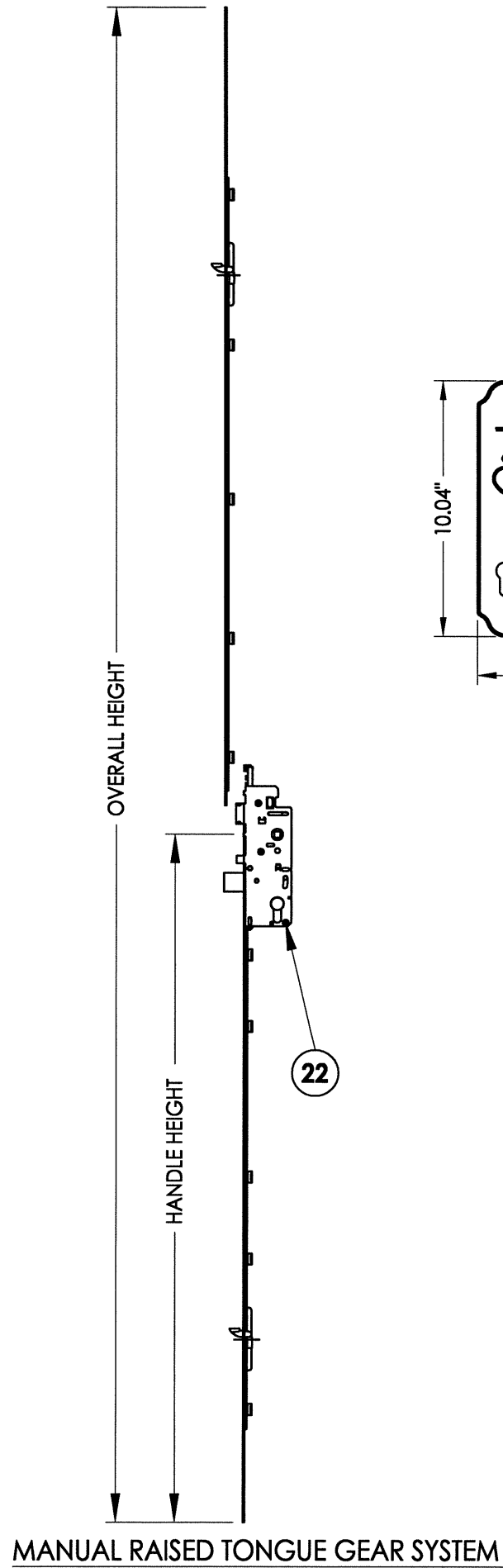

22 **HOPPE MULTI-POINT LOCKSET**
3-Point "Tongue"

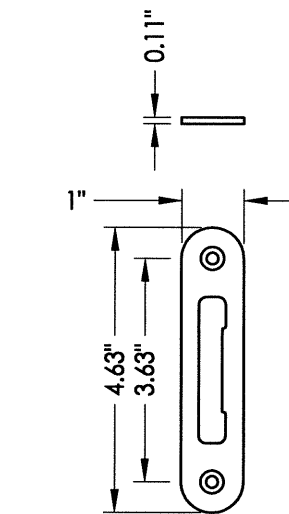

23 **MULTI-POINT STRIKE PLATE**

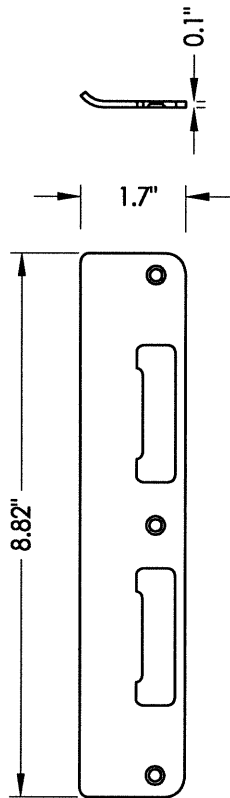

25 **LATCH AND DEADBOLT STRIKE PLATE**
Tongue system

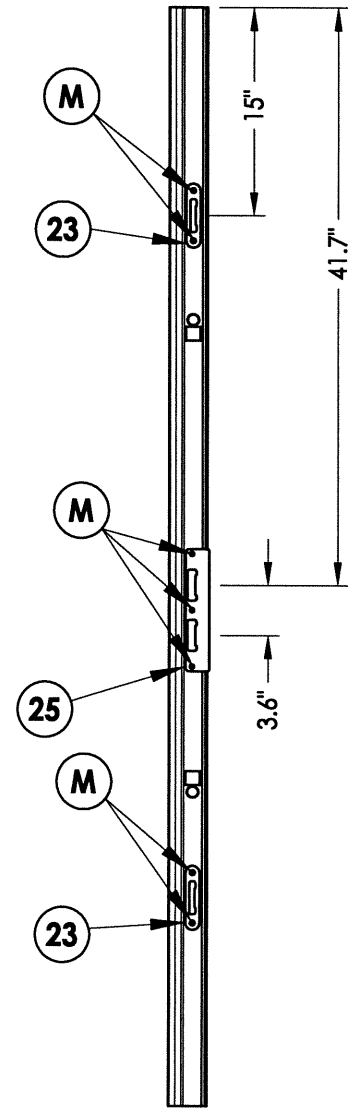

STRIKE JAMB

PRODUCT:

WINCORE
FIBERGLASS DOOR

PART OR ASSEMBLY:
3-POINT LOCK DETAILS

DATE: 05/10/12

SCALE: N.T.S.

DWG. BY: JK

CHK. BY: LFS

DRAWING NO.:

FL-15631.6

SHEET 7 OF 12

Documents Prepared By:

RW BUILDING CONSULTANTS, INC.
P.O. Box 230 Vairico FL 33595
Phone No.: 813.659.9197

Florida Board of Professional Engineers
Certificate of Authorization No. 9813

LFS S-3112
Lyndon F. Schmidt, P.E. No. 43409

REVISIONS

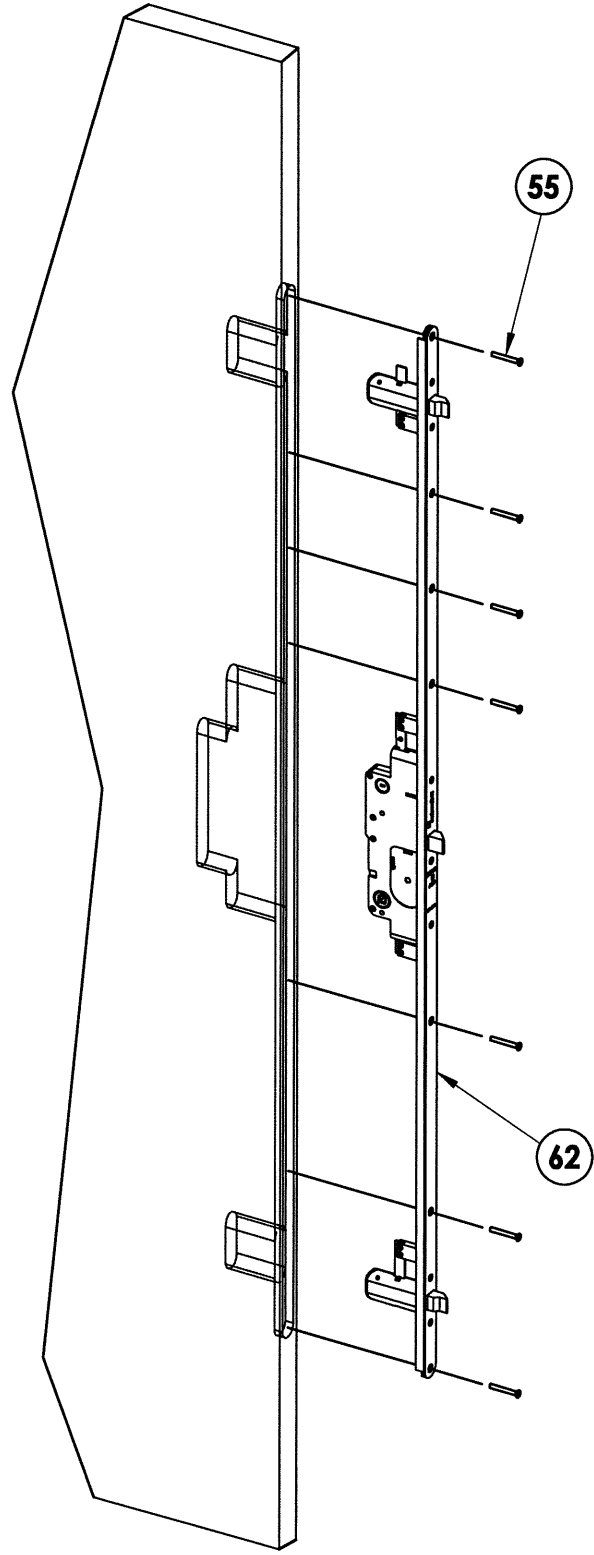

59 **W & F TRILENNIUM 3000 SERIES**
3-Point Lock

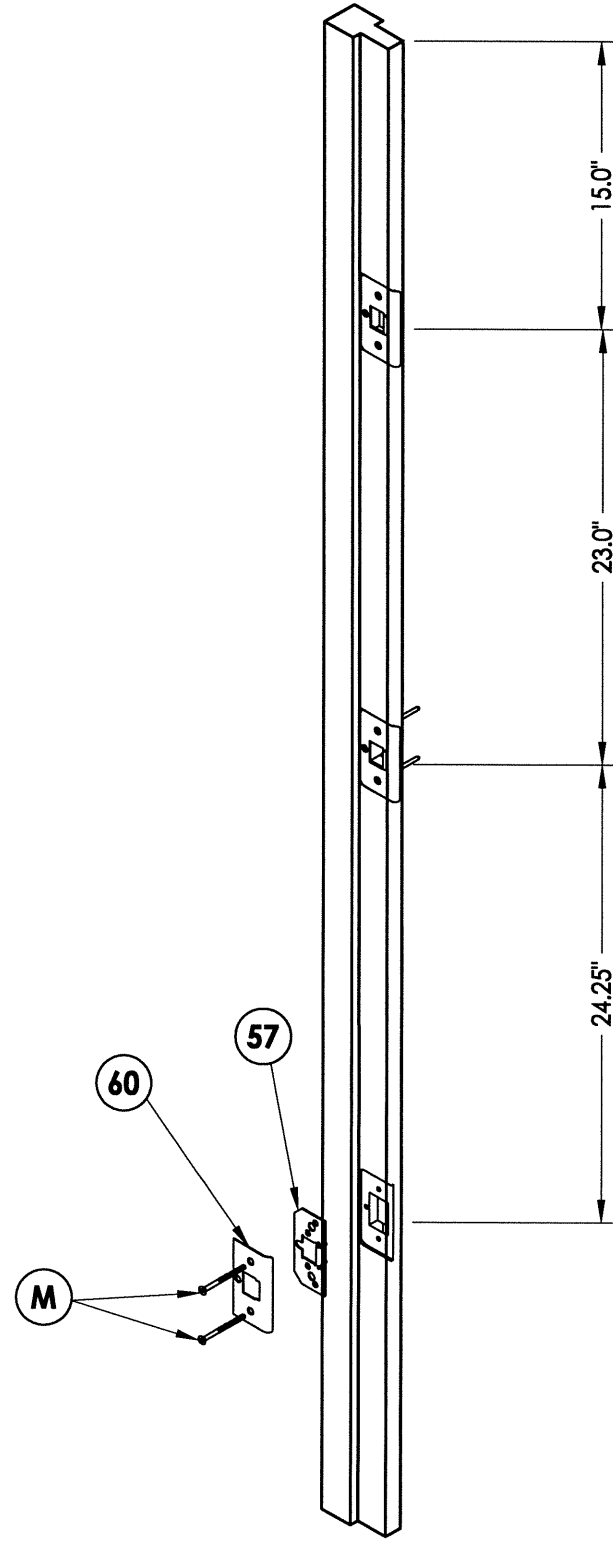

ASTRAGAL STRIKE DETAIL

NO.	DATE	BY

DATE: 05/10/12
 SCALE: N.T.S.
 DWG. BY: JK
 CHK. BY: LFS
 DRAWING NO.:
 FL-15631.6
 SHEET 8 OF 12

PRODUCT: WINCORE FIBERGLASS DOOR
 PART OR ASSEMBLY: 3-POINT LOCK DETAILS

Documents Prepared By:
RW BUILDING CONSULTANTS, INC.
 P.O. Box 230 Vairico FL 33595
 Phone No.: 813.659.9197
 Florida Board of Professional Engineers
 Certificate Of Authorization No. 9813
 Lyndon F. Schmidt, P.E. No. 43409

R:\A - Projects\Project Folders\Proj 1601 - 1700\PF 1671\D. RWBC Drawings\FL-15631.dwg, 9.6

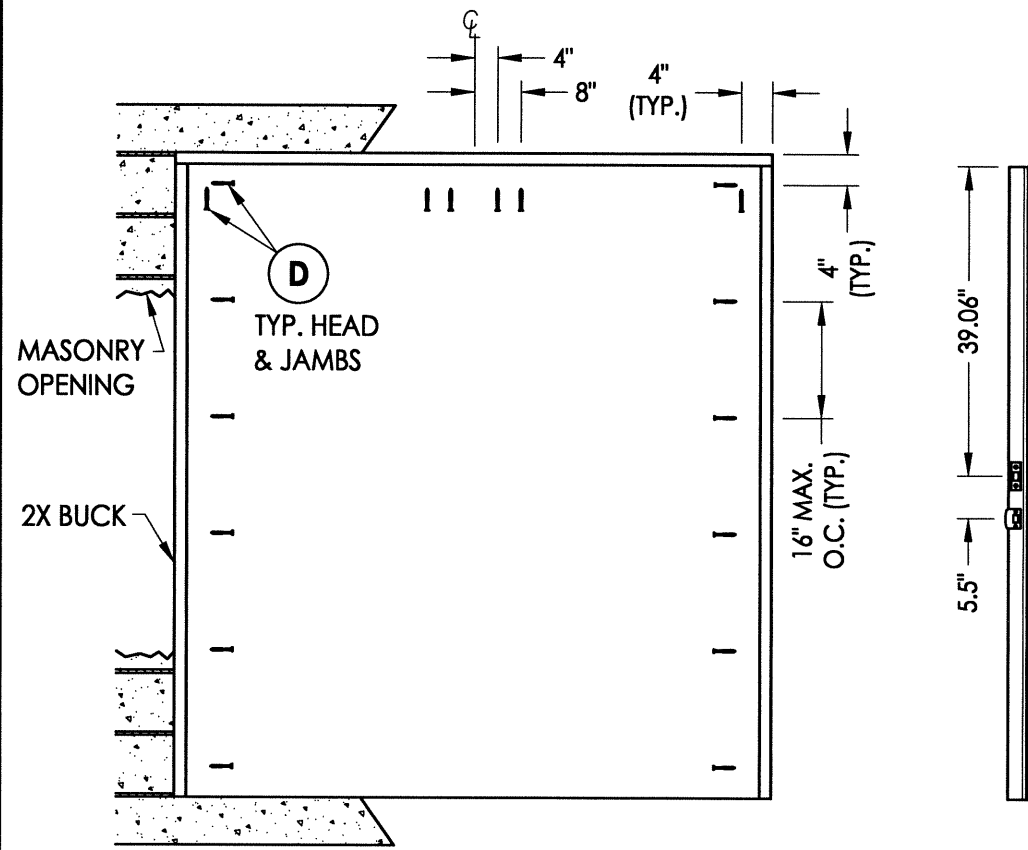

BUCK ANCHORING
XX

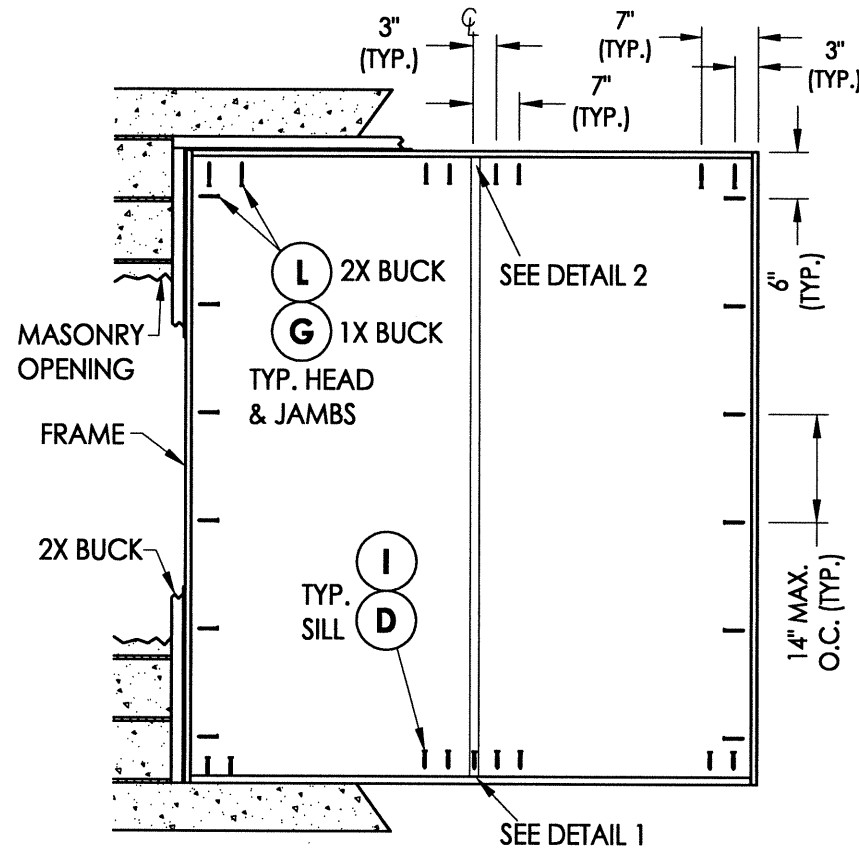

FRAME ANCHORING
XX

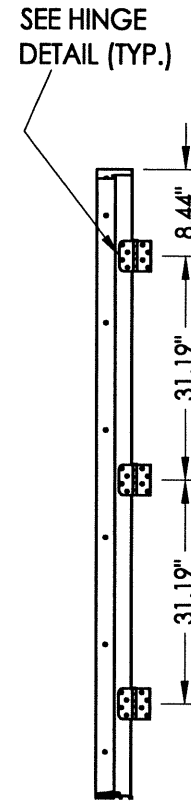

HINGE JAMB

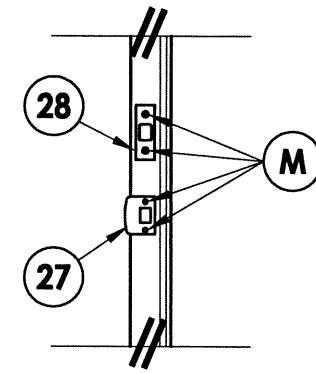

LATCH & DEAD BOLT DETAIL

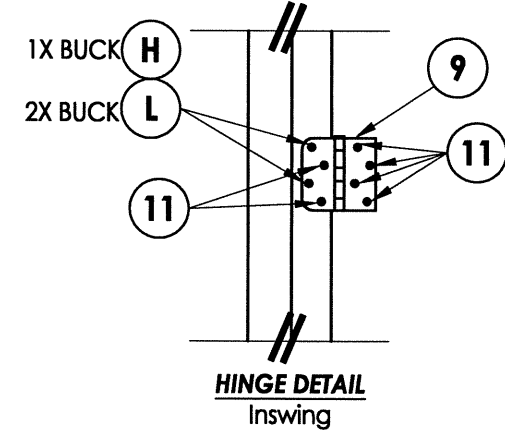

HINGE DETAIL
Inswing

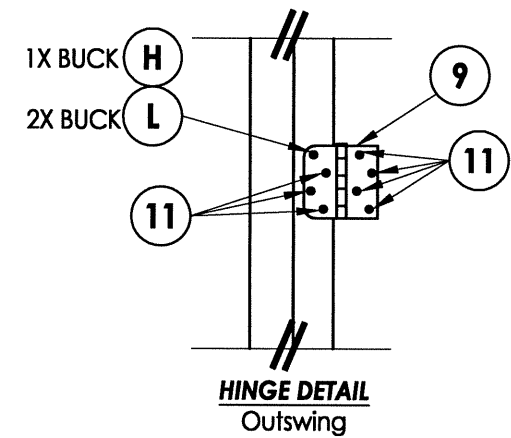

HINGE DETAIL
Outswing

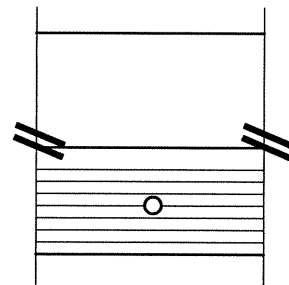

DETAIL 1
Astragal throw bolts
at the threshold
(Outswing)

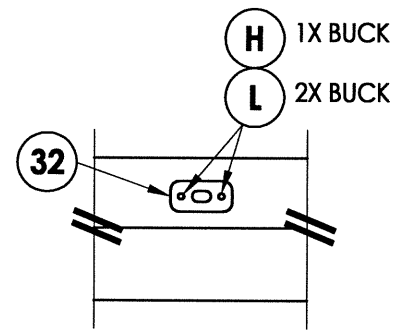

DETAIL 2
Attach astragal throw bolt
strike plate to frame
as shown

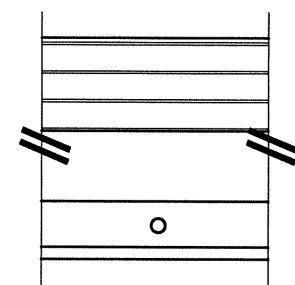

DETAIL 1
Astragal throw bolts
at the threshold
(Inswing)

CONCRETE ANCHOR NOTES:

1. Substitution of equal concrete anchors from a different supplier may have different edge distance and center distance requirements.
2. Concrete anchor locations at the corners may be adjusted to maintain the min. edge distance to mortar joints. Concrete anchor locations noted as "MAX. ON CENTER" must be adjusted to maintain the min. edge distance to mortar joints, additional concrete anchors may be required to ensure the "MAX. ON CENTER" dimension are not exceeded.
3. Concrete anchor table:

ANCHOR TYPE	ANCHOR SIZE	MIN. EMBEDMENT	MIN. CLEARANCE TO MASONRY EDGE	MIN. CLEARANCE TO ADJACENT ANCHOR	PUBLISHED SHEAR VALUE (LBS)
ITW TAPCON®	1/4"	1-1/4"	2-1/2"	3"	264
ITW TAPCON®	3/16"	1-1/4"	2-5/8"	2-1/4"	197
				1-1/2"	131

Documents Prepared By:

RW BUILDING CONSULTANTS, INC.
P.O. Box 230 Valrico FL 33595
Phone No.: 813.659.9197
Florida Board of Professional Engineers
Certificate of Authorization No. 9813
LFS 5.8.12
Lyndon F. Schmidt, P.E. No. 43409

PRODUCT: WINCORE FIBERGLASS DOOR
PART OR ASSEMBLY: BUCK AND FRAME ANCHORING (XX)

NO.	DATE	BY	REVISIONS

DATE: 05/10/12
SCALE: N.T.S.
DWG. BY: JK
CHK. BY: LFS
DRAWING NO.: FL-15631.6
SHEET 9 OF 12

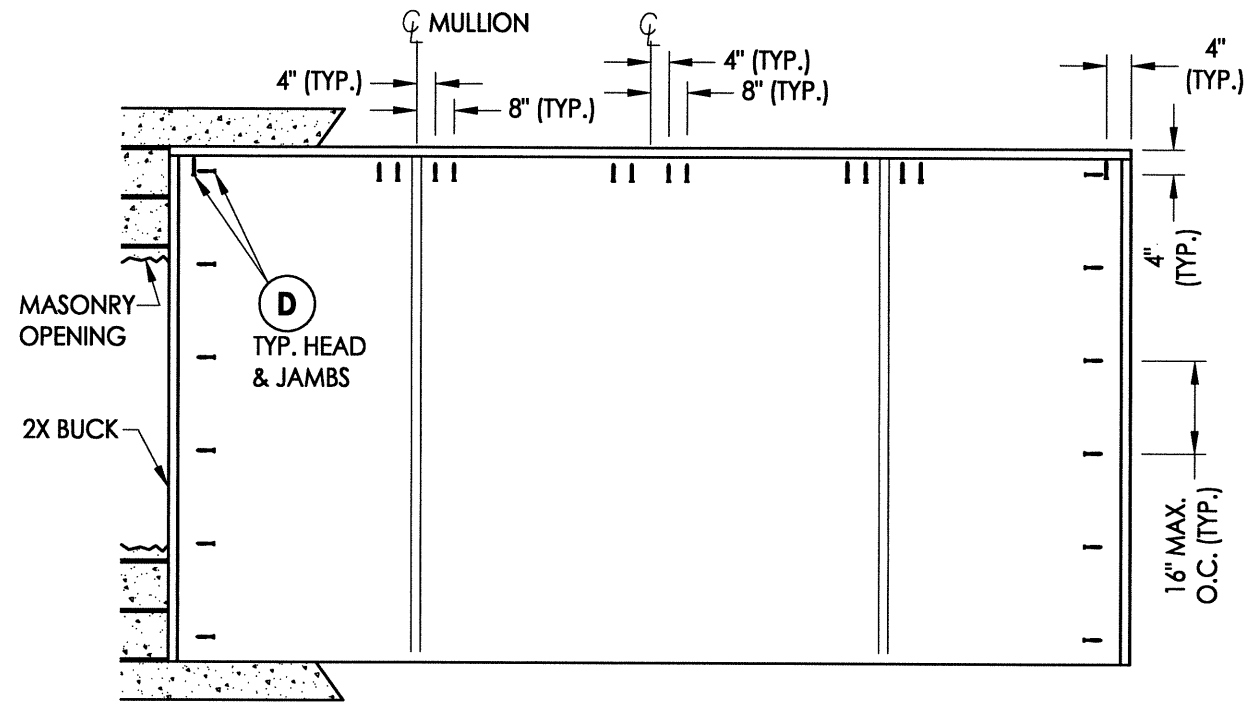

BUCK ANCHORING
OXXO

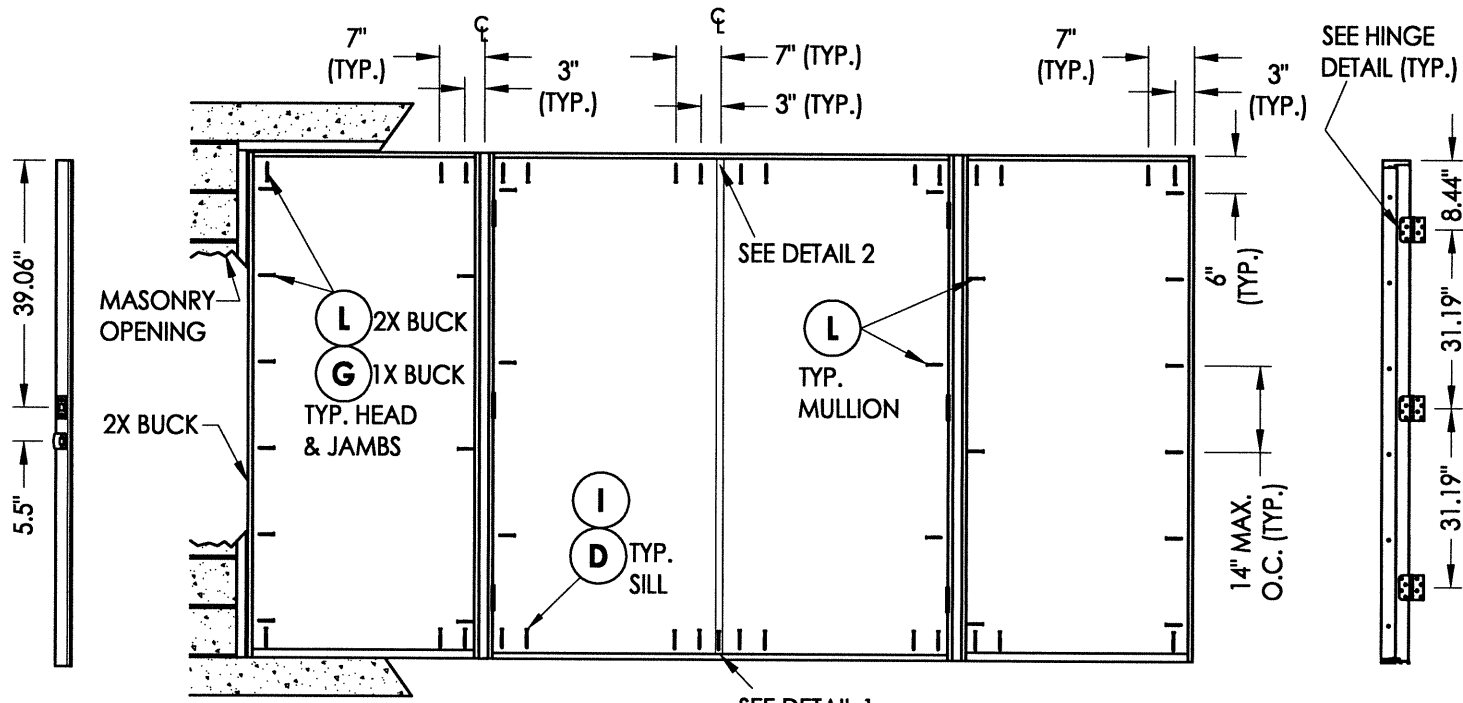

ASTRAGAL STRIKE JAMB

FRAME ANCHORING
OXXO

HINGE JAMB

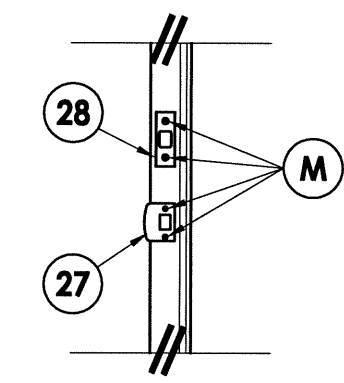

LATCH & DEAD BOLT DETAIL

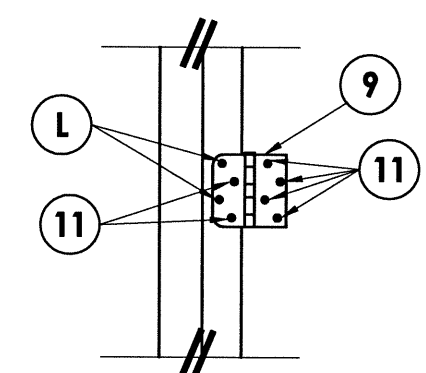

HINGE DETAIL
Inswing

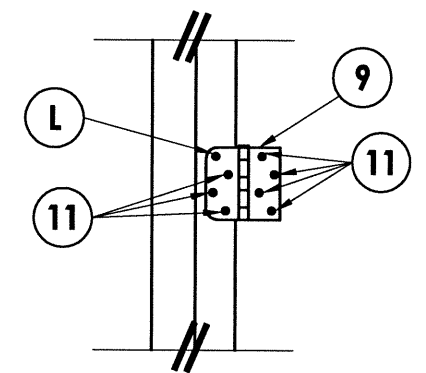

HINGE DETAIL
Outswing

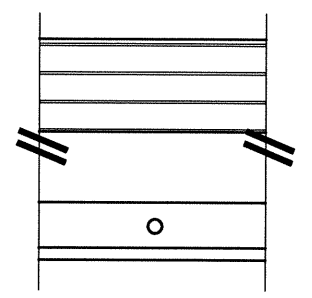

DETAIL 1
Astragal throw bolts
at the threshold
(Inswing)

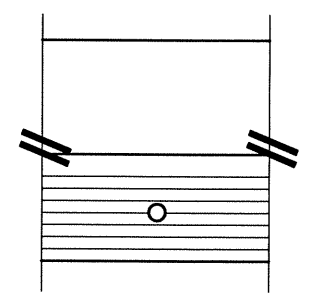

DETAIL 1
Astragal throw bolts
at the threshold
(Outswing)

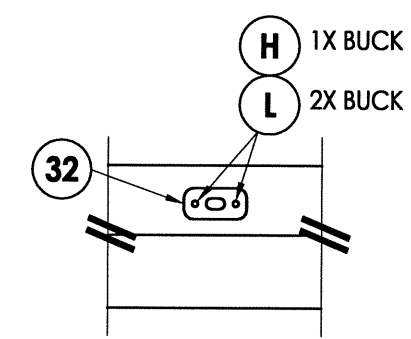

DETAIL 2
Attach astragal throw bolt
strike plate to frame
as shown

CONCRETE ANCHOR NOTES:

1. Substitution of equal concrete anchors from a different supplier may have different edge distance and center distance requirements.
2. Concrete anchor locations at the corners may be adjusted to maintain the min. edge distance to mortar joints. Concrete anchor locations noted as "MAX. ON CENTER" must be adjusted to maintain the min. edge distance to mortar joints, additional concrete anchors may be required to ensure the "MAX. ON CENTER" dimension are not exceeded.
3. Concrete anchor table:

ANCHOR TYPE	ANCHOR SIZE	MIN. EMBEDMENT	MIN. CLEARANCE TO MASONRY EDGE	MIN. CLEARANCE TO ADJACENT ANCHOR	PUBLISHED SHEAR VALUE (LBS)
ITW TAPCON®	1/4"	1-1/4"	2-1/2"	3"	264
ITW TAPCON®	3/16"	1-1/4"	2-5/8"	2-1/4"	197
				1-1/2"	131

Documents Prepared By:

RW BUILDING CONSULTANTS, INC.
P.O. Box 230 Valrico FL 33595
Phone No.: 813.659.9197
Florida Board of Professional Engineers
Certificate of Authorization No. 9813
5.31.12
Lyndon F. Schmidt, P.E. No. 43409

PRODUCT: WINCORE FIBERGLASS DOOR

PART OR ASSEMBLY: BUCK AND FRAME ANCHORING (OXXO)

NO.	DATE	BY	REVISIONS

DATE: 05/10/12
SCALE: N.T.S.
DWG. BY: JK
CHK. BY: LFS
DRAWING NO.: FL-15631.6
SHEET 10 OF 12

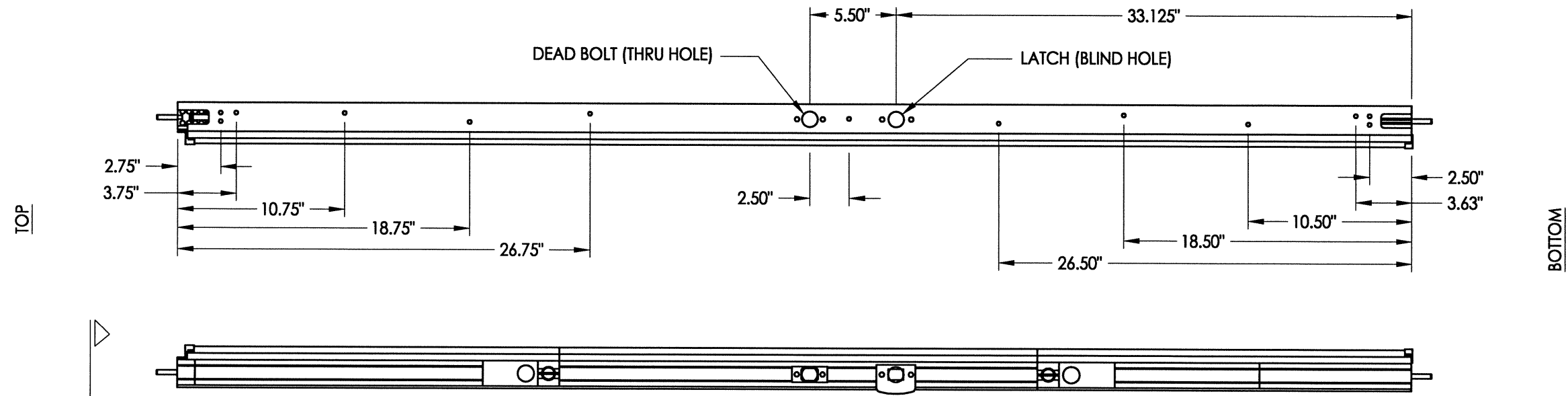

6'-8" ALUMINUM ASTRAGAL ASSEMBLY
By Endura

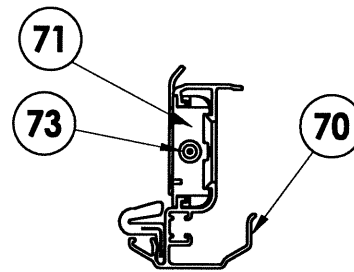

VIEW A-A
Aluminum Astragal Assembly

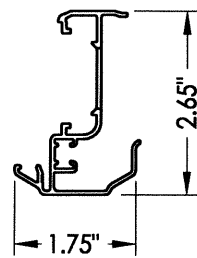

70 ALUMINUM ASTRAGAL
By Endura Product

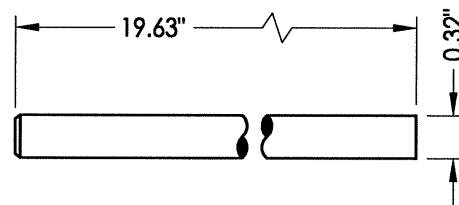

73 SLIDE BOLT ROD
MATL: Steel

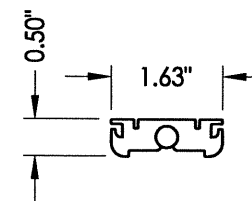

71 BOLT RETAINER
MATL: 9-3/4" Aluminum

PRODUCT:	WINCORE FIBERGLASS DOOR
PART OR ASSEMBLY:	ASTRAGAL DETAILS

NO.	DATE	BY

DATE:	05/10/12
SCALE:	N.T.S.
DWG. BY:	JK
CHK. BY:	LFS
DRAWING NO.:	FL-15631.6
SHEET	11 OF 12

Documents Prepared By:
RW BUILDING CONSULTANTS, INC.
 P.O. Box 230 Vairico FL 33595
 Phone No.: 813.659.9197
 Florida Board of Professional Engineers
 Certificate Of Authorization No. 9813
5.7.12
 Lyndon F. Schmidt, P.E. No. 43409

BILL OF MATERIALS

ITEM #	DESCRIPTION	MATERIAL
A	1X BUCK (G >= 0.55)	WOOD
B	2X BUCK (G >= 0.55)	WOOD
C	1/4" MAX. SHIM SPACE	-
D	1/4" X 2-3/4" PFH ITW CONCRETE SCREW	STEEL
E	MASONRY - 3,192 PSI MIN. CONCRETE CONFORMING TO ACI 301 OR HOLLOW BLOCK CONFORMING TO ASTM C90	CONCRETE
G	1/4" X 3-3/4" PFH ITW CONCRETE SCREW	STEEL
H	3/16" x 3-1/4" PFH ITW CONCRETE SCREW	STEEL
I	1/4" X 1-3/4" PFH ITW CONCRETE SCREW	STEEL
K	#9 X 2-1/2" PFH WOOD SCREW	STEEL
L	#8 X 2-1/2" PFH WOOD SCREW	STEEL
M	#8 X 1-1/2" PFH WOOD SCREW	STEEL
1	POLY FIBER JAMB	COMP. / VINYL
3	EXT. FRAME (ODL)	ALUM.
4	INT. FRAME (ODL)	ALUM.
5	#7-19 X 1-3/4" PPH SELF-DRILLING SMS	STEEL
7	WEATHERSTRIP	FOAM
8	DOOR BOTTOM SWEEP	VINYL
9	4" X 4" BUTT HINGE	STEEL
11	#9 X 3/4" PFH WOOD SCREW	STEEL
12	NON-STRUCTURAL SEALANT	SILICONE
13	STRUCTURAL SILICONE (DOW 995)	SILICONE
22	HOPPE - 3 POINT "TONGUE" MULTI-POINT LOCKSET	STEEL
23	MULTI-POINT STRIKE PLATE (TONGUE SYSTEM)	STEEL
25	LATCH AND DEADBOLT STRIKE PLATE (TONGUE SYSTEM)	STEEL
27	LATCH STRIKE PLATE	STEEL
28	DEADBOLT STRIKE PLATE (SECURITY)	STEEL
29	ADA THRESHOLD	ALUM
30	OUTSWING THRESHOLD	ALUM/WOOD
32	OUTSWING THRESHOLD	ALUM/WOOD
33	OUTSWING THRESHOLD	ALUM/COMP
35	OUTSWING SIDELITE ADAPTER	VINYL
36	INSWING THRESHOLD	ALUM/COMP
39	INSWING SIDELITE ADAPTER	VINYL
40	DOOR PANEL - SEE DOOR PANEL DETAIL SHEET FOR CONSTRUCTION DETAILS	-
50	SIDELITE PANEL - SEE SIDELITE PANEL DETAIL SHEET FOR CONSTRUCTION DETAILS	-
55	#10 X 1-1/2" PFH SCREW	STEEL
57	BACKING PLATE	STEEL
58	#8 X 2" PFH WS	STEEL
59	W & F TRILENNIUM SERIES 3000 - 3 POINT LOCK	-
60	MULTI-POINT STRIKE PLATE	STEEL
62	LOCK ASSEMBLY	STEEL
70	ASTRAGAL BY ENDURA	ALUM
71	BOLT RETAINER (9-3/4")	ALUM
73	SLIDE BOLT ROD	STEEL
88	2X REINFORCEMENT SG >= 0.55	WOOD

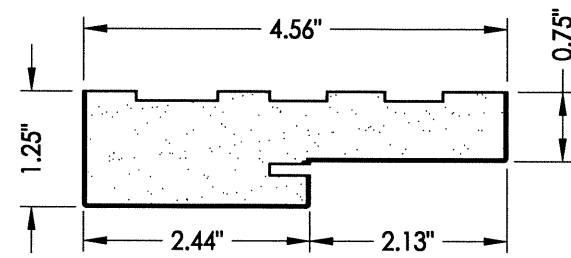

1 POLY FIBER JAMB
Plastpro

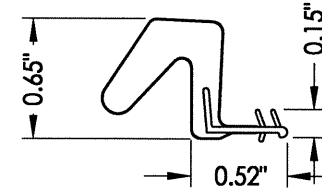

7 WEATHERSTRIP
Endura Force 5

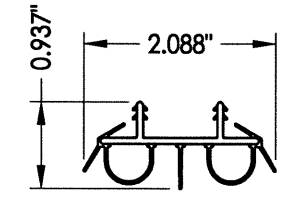

8 DOOR BOTTOM SWEEP

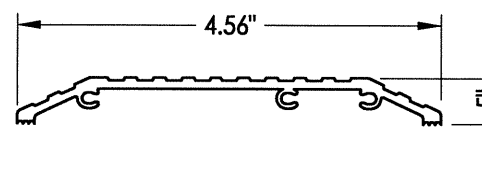

29 ADA THRESHOLD
DLP

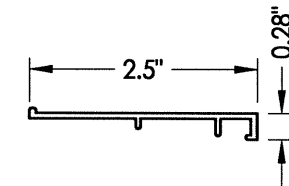

35 OUTSWING SIDELITE ADAPTER

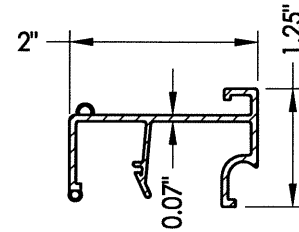

39 INSWING SIDELITE ADAPTER

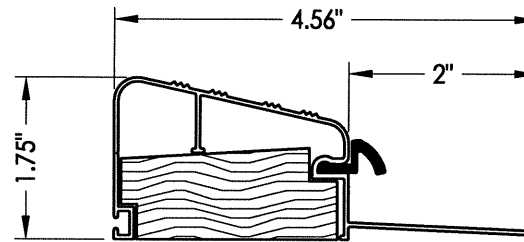

30 OUTSWING THRESHOLD
DLP (QOSR)

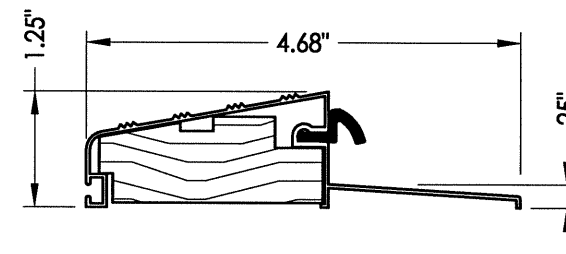

32 OUTSWING THRESHOLD
DLP (QOSH)

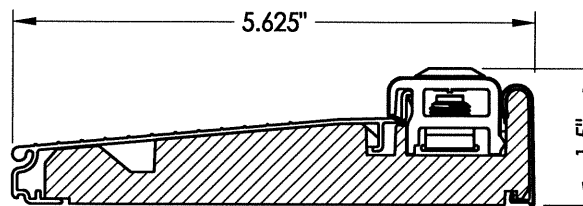

36 INSWING THRESHOLD
Endura (Z-Series)

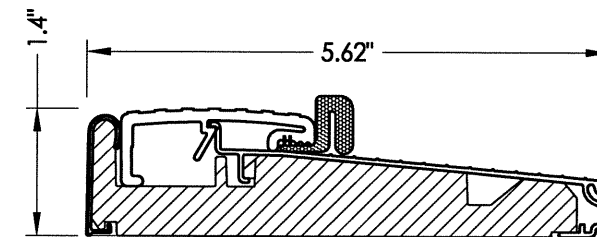

33 OUTSWING THRESHOLD
Endura (Z-Series)

Documents Prepared By:

R.W. BUILDING CONSULTANTS, INC.
P.O. Box 230 Valrico FL, 33595
Phone No.: 813.659.9197
Florida Board of Professional Engineers
Certificate Of Authorization No. 9813
RWS 5.31.12
Lyndon F. Schmidt, P.E. No. 43409

PRODUCT: WINCORE FIBERGLASS DOOR
PART OR ASSEMBLY: BILL OF MATERIALS & COMPONENTS

NO.	DATE	REVISIONS	BY

DATE: 05/10/12
SCALE: N.T.S.
DWG. BY: JK
CHK. BY: LFS
DRAWING NO.: FL-15631.6
SHEET 12 OF 12